

KIRKLEES

**TOP
100**

COMPANIES 2024/25

EVERY WARM WELCOME

UPGRADE YOUR EXPERIENCE WATCHING
THE TERRIERS WITH OUR PREMIUM
SEATING PACKAGES.



WHITE ROSE CLUB



PREMIUM BOXES



CLUB TOWN

EMAIL COMMERCIAL@HTAFC.COM
OR CALL 01484 960613



EVERYTHING
TOGETHER

1908



INSIDE



**KIRKLEES
TOP
100
COMPANIES 2024/25**

Methodology	4
Special Awards	5
5th Anniversary Special	6
Invest in Kirklees	9
Partner Insight	12
The Top 10	14
Innovation Spotlight	22
The Top 100 List	24
Significant Organisations	27
Significant Companies	29
Partner Insight	32
The Top 100 Profiles.....	36
Charities	46

KEEP IN TOUCH:**e-mail:**

Kirkleestop100@hud.ac.uk

X: @KirkleesTop100**LinkedIn:**<https://www.linkedin.com/company/kirklees-top-100/>**Kirklees100.org**

Celebrating Kirklees'

TOP 100 COMPANIES

Welcome to the fifth edition of the **Kirklees Top 100 Companies, showcasing the top companies from across the district that have demonstrated exceptional performance and resilience.**

We're delighted that the Top 100 has reached the key milestone of its fifth birthday and this year's edition includes some special features to celebrate this achievement, including a new award for the most consistent business performance over this period and a retrospective article by Emeritus Professor Jill Johnes, Huddersfield Business School.

The Top 100 initiative goes from strength to strength. Building on existing activities including our Talent group, dedicated Careers Edition of the brochure (now in its third year) and regular social media, new developments this year include launching a new podcast series featuring interviews with inspirational Kirklees business leaders - you can find these by visiting Businesskirklees.com and searching for "Top 100 Podcasts". Many thanks to local production company Giant Leap Productions for bringing this to life.

We also partnered with local charity Fresh Futures, who do amazing work supporting vulnerable and disadvantaged young people and families, to host our summer networking event.

The Top 100 list is produced by Huddersfield Business School using published accounts data from the FAME BVD database and based on five criteria related to financial performance, as explained in the methodology article on page 4.

As in previous years there have been some interesting moves up and down the rankings and 12 businesses featuring in the Top 100 for the first time. One business features in the top 10 for the first time. From a sectoral perspective, just over half (51) of the Top 100 companies are in the

manufacturing or engineering sectors and 26 are in wholesale or retail.

The 2024/25 edition also showcases the University of Huddersfield's groundbreaking National Health Innovation Campus, located in the heart of Huddersfield town centre; shines a spotlight on local businesses going the extra mile to invest in their existing and future workforce; and details the work of the University in supporting Apprenticeships. We also highlight some of the exciting regeneration and infrastructure investment taking place across the district and why Kirklees - perfectly positioned between Leeds, Manchester and Sheffield - is the perfect place to start, grow and invest in business.

Finally, we'd like to extend a massive thank you to our sponsors for their very generous support in backing the Kirklees Top 100 initiative again this year - employment law/HR specialists Howarths UK; Langricks chartered accountants and Huddersfield Town AFC. You can find out more about their work inside.

We hope you enjoy learning more about Kirklees Top 100 Companies for 2024/25.



**Professor Bob Cryan CBE DL
CMgr CCMi FEng
Vice-Chancellor and Chief Executive
University of Huddersfield**

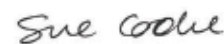

**Sue Cooke
Chief Executive
3M Buckley Innovation Centre**



**Cllr Carole Pattison
Leader, Kirklees Council**

Please note: Inclusion in the Kirklees Top 100 Companies listing is based on objective criteria using company accounts published in the FAME BVD database prior to 1st July 2024 and does not imply the endorsement of the partner organisations listed above.

The Kirklees Top 100 2024/25

HOW THE LIST WAS COMPILED

Background

As in all previous editions of this listing, the Kirklees Top 100 was compiled this year using as its source the FAME BVD database which contains a variety of information on more than 11 million companies in the UK and Ireland. The information includes financial data, information on directors, and company structure including shareholders, subsidiaries and branches, and industry descriptions and SIC codes; much of the data derives from accounts and documents filed at Companies House (in the UK). The FAME BVD database is the only source used to derive the metrics in the listing.

Strict parameters were used to derive the set of companies from which the Top 100 were ultimately drawn. In terms of geographical location, we selected from the FAME BVD database all active companies with a registered office address within the Kirklees region defined as having a postcode in Kirklees (as per the NUTS 3 level region definition). The relevant data was downloaded on July 1st, 2024; any data available in the FAME BVD database after this date was not included in this edition of the Top 100 list. To ensure a Kirklees focus, any company whose website presents as its only contact an address outside of Kirklees was removed even though their registered office was recorded in FAME as in Kirklees. This affected only a very small number of companies.

Methodology

The Kirklees Top 100 ranking is derived from the following indicators: staff head count (i.e. number of employees); turnover; growth in turnover between the latest and previous years accounts; profit before tax; and shareholders' funds. Each of these

indicators is ranked (best- to lowest-performing), and then these rankings are summed. The final position is determined by ranking the sum of ranks. Thus, each of the five metrics carries equal weight in determining the final ranking. This is the same methodological approach as in our previous four editions.

The period over which the ranking applies is determined by the latest information held in FAME BVD and filed by each company in the Kirklees list. Where we identified subsidiaries and sister companies, we applied a consistent approach to ensure that the highest or largest company (in terms of revenue) in the hierarchy was retained, so long (of course) as the registered office was in the defined Kirklees area. Companies deemed to be charities or in the education sector (all levels), or with turnover less than £1000 or with non-numeric data were removed from the data set. No businesses were offered the option of being included (or not).

Economic context

Companies continue to face external challenges. While the restrictions of the Covid-19 pandemic are a thing of the past, the lingering impact of the pandemic, as well as Brexit, continue to challenge businesses.

More recently there are new challenges: the wars in Ukraine and the Middle East, the ongoing impacts on supply chains and commodities, and inflationary pressures which have led to interest rates at a 15-year high as at the data download date. In terms of this list, it should be remembered that each company's data is a specific snapshot (indicated by the date in the "Latest Account Date" column) and so the extent of the impact of precise external factors on businesses in this list varies by company.

Kirklees Context

As always, the Kirklees Top 100 showcases the variety of businesses thriving in our area, and as expected, the type of businesses doing well varies with the changing economic environment.

This year, five of our Top 10 companies are in the manufacturing sector (with a couple of those in the medicinal and botanical area). Alongside these manufacturing companies we have businesses working in transportation and construction. The variety of sectors broadens as we go down the list and Kirklees continues to have a vibrant and diverse business economy from a wide range of sectors.

Limitations

This list does not claim to indicate each business's economic importance to the Kirklees geographical area.

It is based on five specific metrics which are deemed to be indicators of success. All metrics contribute equally to the final ranking. The list is a means of showcasing and celebrating business activity in the Kirklees region. Unfortunately, not all companies' complete set of data are included in FAME BVD, and so businesses which might expect to be in the list are not for that reason. Kirklees also hosts important businesses which do not have a registered primary address in the region, yet their contributions to the Kirklees region may well be substantial. These businesses, along with major public sector organisations, are showcased separately in this publication and are not in any ranked order.



Emeritus Professor Jill Johnes,
Huddersfield Business School

HIGHEST CLIMBER

Sponsored by Howarths

Howarths

FLEXITALLIC UK LTD

Flexitallic has climbed 82 places, from number 93 last year to number 11 in this year's edition.

Flexitallic is the market leader in the manufacture and supply of static sealing solutions, delivering high quality gaskets and providing support and engineering services on a global scale.

The Flexitallic Group is committed to its mission of "Making the world safer and cleaner through engineered sealing solutions". It strives to achieve this by providing best-in-class sealing solutions for established industries such as oil & gas, energy and chemical sectors, as well as emerging technologies supporting hydrogen, carbon capture and fuel cells. Its goal is to help customers navigate the energy transition by providing innovative solutions and services.

Flexitallic offers a Total Joint Integrity approach. It specialises in bolted joint integrity and has a team of Application Engineers dedicated to supporting end users, when faced with problematic sealing applications.



HIGHEST PLACED SME

Sponsored by Langricks

LANGRICKS

Chartered Accountants | Wealth Management

COGRI GROUP LIMITED



Our highest placed SME (small to medium enterprise) and 9th overall in this year's list is CoGri Group Limited.

CoGri Group has offices across the globe and its headquarters are in Huddersfield. The company, established in 1989, specialises in warehouse, industrial, and commercial flooring.

The group is a consortium of international flooring specialists, and collectively it offers a complete package solution for the design, construction, upgrade, repair, and enhancement of industrial floors, particularly for robotics and automated systems, and floor flatness in narrow aisles. Passionate about what it does the Group is a member of The Concrete Society, the British Standards Institute (BSI), the UK Material Handling Association (UKMHA), the Association of Concrete Industrial Flooring Contractor (ACIFC) and the UK Warehouse Association (UKWA).

HIGHEST NEW ENTRANT

Sponsored by Huddersfield Town AFC



ALFRED BAGNALL AND SONS LIMITED

Trading as Bagnalls, Alfred Bagnall and Sons Limited placed 6th in the list this year.

There's a reason we haven't seen Bagnalls in the Kirklees Top 100 before and that is because it has only recently moved into Kirklees.

Its head office has moved from Shipley to Cleckheaton. The company is passionate about staff development and take on apprentices at each of its 12 sites every year. It even has a dedicated training facility in Doncaster which allows its apprentices to develop their skills.

The company is a proud family-run business and is looking forward to celebrating its 150th anniversary in 2025.



FIVE YEARS OF KIRKLEES TOP 100

Background

As we launch the 5th edition of the Kirklees Top 100 it seems like a good time to reflect on what we have learned about the Kirklees business environment over the five lists and what we'd like to achieve in the future. The partners first got together in late 2019 to consider the possibility of producing a Kirklees Top 100 list of companies, when we articulated our aims and objectives:

- To strengthen bonds between the Kirklees business community.
- To raise the profile of Kirklees businesses and the district as an attractive destination for inward investment, business start-up, scale-up and growth.
- To instil prestige for members of the Kirklees Top 100 Companies and offer the benefits of exclusive networking and relationships between members.
- To better co-ordinate the efforts of the major anchor institutions in developing 'key account' relationships with the Top 100 Companies and ensuring they are well connected into dialogue about the future of the Kirklees economy.
- To broker stronger relationships between the Top 100 Companies and founding partners to increase the take up of local talent; education and skills initiatives; innovation and business support; and other appropriate initiatives.
- To encourage stronger engagement between smaller firms and those larger

organisations on the Kirklees Top 100 Companies list to encourage greater collaboration, sharing expertise and business opportunities.

Having agreed on the objectives and the methodology which would be used to compute the list, we were faced with the pandemic and accompanying lockdown. We questioned whether 2020 was the time to launch the Kirklees Top 100 and quickly agreed that with the challenges facing businesses at that time and the gloomy economic outlook, it was actually the perfect time to celebrate business achievements and resilience, and to provide support and networking opportunities for our local businesses.

The on-going challenges of the pandemic meant that our first two launch events were virtual, and it wasn't until summer of 2022 that we had our first face-to-face networking event, with the launch of the third edition at the John Smith's Stadium in October 2022 being our first in-person launch event.

As the momentum of and interest in the Kirklees Top 100 activities grew, we introduced an annual Careers Edition in autumn of 2020 to raise awareness amongst students in schools and the university of opportunities in local companies, and we launched a special SMEs edition in summer of 2023, thereby initiating links between the top-performing larger companies in the region and the fast-growing SMEs - all part of our initiative objectives.

As we launch our fifth edition it's worth taking a step back and looking a bit more closely at the companies and performance across the Kirklees Top 100 listings.



October 2022: Launch of Kirklees Top 100 2022/23, John Smith's Stadium

Consistent performance

Over the five editions around 170 different Kirklees companies have appeared in the listings, and just under one quarter of these have been in every single one of the five listings. We might describe these as the companies in Kirklees which have been showing extraordinary resilience in challenging times and performing consistently well over the five listings.

If we focus on the 39 companies which have appeared in all five Kirklees Top 100 listings, we can see that the vast majority of these are in the manufacturing sector. Kirklees' manufacturing history therefore appears to continue to dominate today's successful business environment.



In addition, a substantial proportion of the consistent performers are businesses involved in the management

of companies and enterprises, and those involved in wholesale trade - see figure above.

Company	Average ranking
PPG Architectural Coatings UK Limited	6.6
Thornton & Ross Limited	9.0
The Simplybiz Group plc/ Fintel plc	10.6
Isaac Timmins Limited	12.2
UK Greetings Limited	15.4
Mabey Hire Limited	16.4
Continental Wine & Food Limited	16.8
Jemmtec Limited	18.8
Aflex Hose Limited	21.0
FMG Support Group Limited/ FMG Support (RRRM) Ltd/ FMG support (FIM) Ltd	23.2

The top ten of these companies and their average ranking over the period are displayed in the table above. The performance of these top 10 companies is truly exceptional - the top two are in the top 10 on average across all five years of the listing demonstrating consistently outstanding performance across economically challenging times.

Size of Kirklees Top 100 Companies

Kirklees Top 100 companies are not, as a group particularly large, with an average number of employees of between 200 and 330 - it's interesting to note that the average was generally falling for the first four listing editions but has seen a small rise in the latest year.

It's difficult to read too much into such a small number of observations but it's tempting to suggest that the pandemic and subsequent economic hits to business had a detrimental effect on employment and we might now be seeing a bounce back, but we will be able to see more as we produce

subsequent editions of the Kirklees Top 100. This pattern is broadly mirrored by the median number of employees, values of which are considerably lower than the average suggesting that, as you might expect, there is a long tail of smaller companies in the list.

Nevertheless, as the figure below shows, while the majority of companies are largely below 250 employees (falling into the SME size range based on employee numbers), Kirklees is host to a number of large companies. On average across the five editions, 10 companies in the list exceed 500 employees.

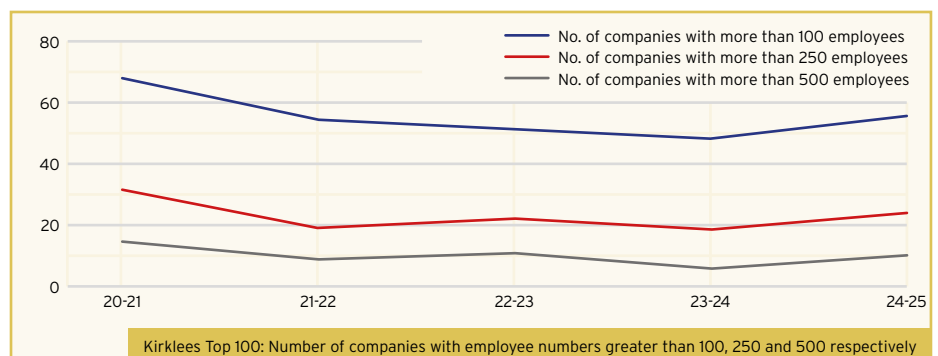

5TH ANNIVERSARY SPECIAL AWARD – MOST CONSISTENT PERFORMANCE

PPG ARCHITECTURAL COATINGS UK LIMITED

The 5th Anniversary Special Award for the most consistent performance is awarded to PPG Architectural Coatings UK Limited. Over the last 5 years PPG had the highest average position.

For more than 140 years, PPG has been at the forefront of developing and delivering paints, coatings, and specialty materials. With a commitment to innovation and excellence, PPG collaborates closely with clients to address their most pressing challenges. Headquartered in Pittsburgh, USA, PPG operates in more than 70 countries and reported net sales of \$18.2 billion in 2023.

The PPG plant in North Kirklees is its largest paint manufacturing complex in Europe. Since 1983, PPG, the renowned maker of the Johnstone's and Leyland

paint brands, has operated from its expansive 65-acre site in Birstall. Employing over 1,500 people across the UK and Ireland, PPG has a significant presence in the region.

PPG's strong commitment to social responsibility is exemplified by its Colourful Communities programme, which encourages employees to volunteer their

time and utilise PPG products to enhance their local communities.

In 2023, PPG Architectural Coatings UK began a partnership with STEM Learning UK, pledging funding to support both local schools around Birstall, and 58 teachers across the UK, in continuing professional development (CPD) courses offered by STEM Learning.



Over 60 employees volunteered to support the latest PPG Colourful Communities project at Gomersal Primary

Geographical location

The map to the right, with the Kirklees region outlined in dark blue and shaded in light blue, permits scrutiny of the location of the Top 100 companies - the orange markers show the companies in the latest edition, but it is reflective of earlier editions too.

Clearly many of our Top 100 companies are located in and around Huddersfield, and on the fringes of other urban areas such as Leeds and Wakefield. But what is particularly noticeable is that many of our Top 100 are located close to the A62 and M62 suggesting good road connections are important for these successful companies.

The more rural areas in the south of the Kirklees region are much less populated with Kirklees Top 100 companies, and this makes an interesting contrast with the Kirklees Top 100 *Focus on SMEs* listing produced in 2023 where we found more of a spread across the region (see blue markers).

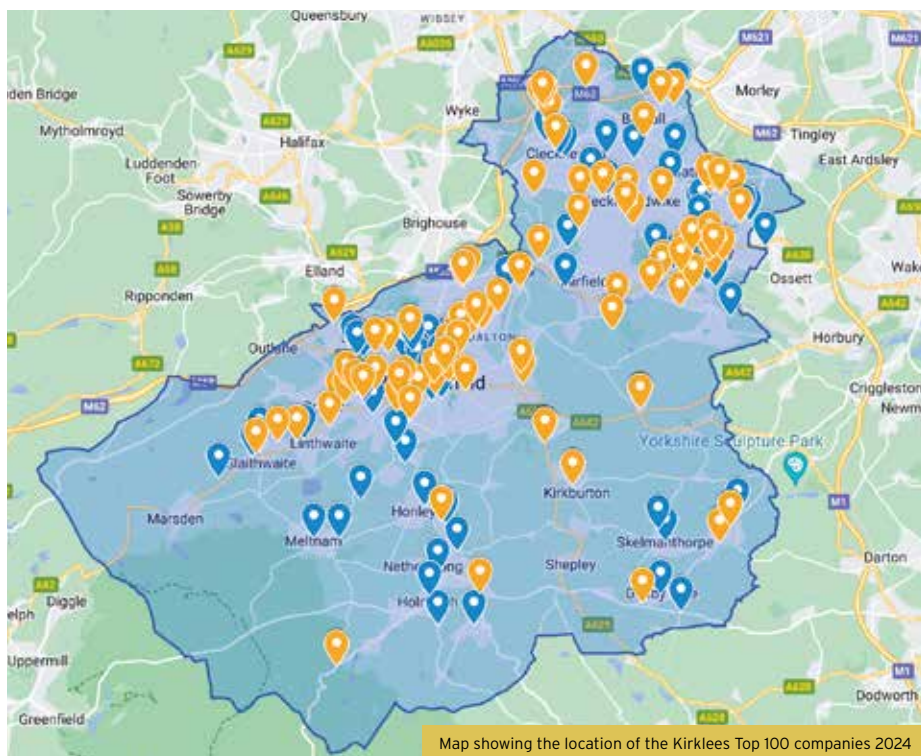

Kirklees Top 100 networks, networking and social media

Since the launch of the first Kirklees Top 100 listing in October 2020 up until summer of 2024, there have been 10 official networking events attracting over 550 registered attendees.

The events include four main edition launches, three Careers Edition launches and three summer networking sessions. In addition, the partners have overseen and supported some specialist networks. The Talent Group has been meeting since 2021,

has had eight events with 102 registered attendees, and has explored themes such as graduate development, recruitment and retention, hybrid working, and the cost of living crisis. These meetings have been held online and in-person at different organisations across Kirklees including STADA (Thornton & Ross) in Slaithwaite and UK Greetings in Dewsbury. The Environmental Group, led by Kirklees Council, has already met twice with another meeting planned for November.



Professor Tim Thornton makes the presentation to the 2023/24 Kirklees Top 100 winner: Isaac Timmins Limited

In addition, there is a dedicated LinkedIn account for the Kirklees Top 100 with over 1000 followers raising awareness of the Kirklees business environment and publicising good news relating to Kirklees Top 100 companies. The Kirklees Top 100 website (<https://kirklees100.org/>) provides access to all the listings and specialist brochures and is a resource available to all.

Through the publication of the first five editions of the company listing, the Kirklees Top 100 has successfully showcased the excellence, diversity and resilience in the Kirklees business environment. We, the partners, are very much committed to continuing to showcase and support businesses and their success in future editions of the Kirklees Top 100.



Partners and sponsors attending the Kirklees Top 100: Focus on SMEs event, June 2023

LOOKING TO THE FUTURE: Kirklees £2bn investment

Driven by an ambitious vision for the future, Kirklees is witnessing significant investment, with a range of high profile and impactful projects across the district already underway or at an advanced stage of development.

Sustainable, long-term, inclusive growth in Huddersfield, Dewsbury, Batley, Cleckheaton, Heckmondwike, Holmfirth and Marsden is being fuelled by a comprehensive approach to regeneration, strong leadership from both the public and private sectors, responsible investment, and thriving high-growth businesses.

Our rich culture, scenic landscapes and strategic location provide a high quality of life, attracting investors and residents alike - with the best yet to come.

A series of community-led masterplans or Blueprints are catalysing the regeneration of town centres, enhancing connectivity and delivering improved public realm, infrastructure, culture and business growth through targeted investments that will see more than £2bn of planned private and public infrastructure investment over the next ten years.

CONNECTIVITY IS KEY

Making us one of the best-connected places in the North of England, modernisation of Kirklees' public transport system is taking place at pace.

Kirklees lies at the very heart of the Transpennine Route Upgrade (TRU) - the largest infrastructure investment programme currently being undertaken in the UK. This multi-billion pound railway improvement programme will double network capacity, substantially enhance Huddersfield, Dewsbury, Marsden, Slaithwaite, Mirfield and Ravensthorpe stations at pivotal locations along the route, and reduce journey times to Leeds, York, and Manchester.

Alongside TRU, the West Yorkshire Combined Authority is investing over £42m to revitalise bus stations in Dewsbury, Heckmondwike and Huddersfield. This will boost usage, improve connectivity between



our bus and rail networks and ensure Kirklees is well placed to benefit from future plans to bring bus services under public control.

Kirklees is also part of the Combined Authority's plans for Mass Transit, with proposals to connect Leeds and Dewsbury in the future.

OVER £1BN INVESTMENT IN HUDDERSFIELD TOWN CENTRE

Huddersfield is witnessing a significant transformation, with a range of high profile and impactful projects underway, breathing

new life into historic buildings and future-proofing Huddersfield as a great place to live, work and invest. Phase 1 of the £250m Our Cultural Heart development is underway, creating a dynamic new cultural hub. Public realm improvements across the Town are breathing new life into the retail quarter, plus the ongoing £9.2m redevelopment of Kingsgate shopping centre will further enhance the towns leisure offer, providing a new six screen cinema, bowling and leisure complex.

The iconic George Hotel is undergoing restoration to become a brand new Radisson RED and the Town's historic Victorian market is set for a £16m restoration breathing new life into the Grade 2 listed building and creating a new hub for start-ups.

Beyond the Blueprint, there are ambitious plans for the Station to Stadium Enterprise Corridor, a long-term strategic investment corridor connecting Huddersfield's Railway Station to the John Smith's Stadium. It's home to the West Yorkshire Healthtech and Digital Tech Investment Zone that will accelerate innovation, jobs and growth in the health and life science sectors, underpinned by the University of Huddersfield's £250 million National Health Innovation Campus development, creating the largest, most dynamic centre for healthcare innovation and workforce development in the North of England.





Dewsbury Creative Town Arts Programme, Emmeline North

ALL CHANGE FOR DEWSBURY

Dewsbury is a leading force in the bed and furniture manufacturing industries. This multicultural town is known for its affordable commercial property and its excellent location, close to Leeds and key road networks. It's in a key location to take advantage of the proposed West Yorkshire Mass Transit scheme.

The Dewsbury Blueprint highlights significant opportunities to transform the town through investments in residential and office schemes, rejuvenating the public realm, retail and business space. Key projects supported by the Government's Towns Fund programme include the revitalisation of Dewsbury Arcade (now on-site) and Dewsbury Market with the potential to transform the town centre.

Complementing the regeneration of Dewsbury Town Centre, major development sites at Chidswell and Dewsbury Riverside will deliver circa 5000 homes and over 1.5 million ft² of employment land over the next decade, benefitting from their proximity to the TRU and proposed Mass Transit schemes.

“

An ambitious centrepiece for Huddersfield and Kirklees, Our Cultural Heart will breathe new life into the town centre creating a vibrant, inclusive and social destination for all.



IT DOESN'T STOP THERE

Kirklees is home to picturesque countryside dotted with distinctive market towns and villages including Batley, Mirfield, Holmfirth, Meltham, Marsden, Slaithwaite, Kirkburton and Denby Dale.

These areas are not only popular with tourists, but also for entrepreneurs and businesses in the retail, digital and creative sectors. Investment focusses on celebrating each town centre's heritage whilst making positive changes for the long term sustainability and growth of the local economy.

Slaithwaite is home to the recently refurbished Innovation Business Hub Globe. In Holmfirth, work is underway to deliver the £10 million Town Centre Access Plan scheme prioritising sustainable transport. In recent years, both towns have been rated some of the top places to live by The Sunday Times.

PERFECTLY PLACED

Part of the Yorkshire and the Humber region, Kirklees is the third largest metropolitan district in the UK, and in the heart of West Yorkshire.

Perfectly positioned at the crossroads of Leeds, Manchester and Sheffield, Kirklees' strategic and beautiful location is an ideal hub for businesses to thrive and expand, at the heart of the Northern Powerhouse. Our rich culture and heritage, outstanding countryside, affordable homes and connections to major cities offer a great quality of life for those that live and work here.

Our dynamic and forward-thinking approach to development and sustainable growth, and global reputation for innovation and collaboration in advanced precision engineering, manufacturing, technical textiles, and health and life sciences, make Kirklees an exceptional place to invest and do business.

“

Our strategic location, and dynamic and forward-thinking approach to development and sustainable economic growth, make Kirklees an exceptional place to invest and do business.

Find out more

There's never been a better time to invest in Kirklees. Contact the team to discuss investment opportunities, business support and locating your business in Kirklees.

businesskirklees.com/invest

invest@kirklees.gov.uk



Our Cultural Heart - artists impression, Huddersfield town centre

DRIVING HEALTH INNOVATION

Huddersfield is becoming a significant hub for health innovation in the UK, driven by efforts to improve health outcomes and productivity across the region. At the heart of this is the University of Huddersfield's National Health Innovation Campus (NHIC) that aims to reshape the healthcare landscape.

With its first building opening in September 2024, the National Health Innovation Campus (NHIC) aims to create a world-class hub for healthcare innovation where researchers, clinicians and industry partners work together to tackle some of the most pressing health challenges locally, nationally and internationally.

Named after the first black NHS matron, the Daphne Steele Building will be the first on campus, housing a Health and Wellbeing Academy and world-leading research facilities. It will also offer public services, including telehealth, podiatry, sports and physiotherapy clinics and a mock-up residential home.

Specialist clinical and allied health professional teaching spaces will equip students and practitioners with the skills and knowledge necessary to thrive in a rapidly evolving healthcare environment. This focus on education and workforce development is essential for ensuring that the healthcare workforce is prepared to meet future challenges.

The NHIC is strategically located within the 'Station to Stadium' enterprise and innovation corridor in Huddersfield, a focal point for the West Yorkshire Healthtech and Digital Tech Investment Zone, announced earlier this year by the UK government. This location positions the NHIC as a key player in the wider region's economic regeneration efforts, addressing both local health disparities and the £8.5 billion job productivity gap between West Yorkshire and the UK average.

Complementing the NHIC is the Huddersfield Health Innovation Partnership (HHIP), a dynamic collaboration between the University of Huddersfield, 3M Buckley Innovation Centre (3M BIC), Business Kirklees, Mid Yorkshire Teaching NHS Trust, Calderdale and Huddersfield NHS Foundation Trust and other local and regional health and wellbeing partners, including Health Innovation Yorkshire & Humber.

It fosters partnerships between academia, industry, healthcare providers and the third sector to accelerate innovation into real-world health solutions. Businesses get access to technology, mentoring, grants, expert knowledge and collaborative opportunities with the NHS and academia, to develop innovative products and services in health and wellbeing. This project is part-funded by the UK Government through the UK Shared Prosperity Fund.

The University is building a new Health and Wellbeing Innovation Centre, based on the same model as the 3M BIC but focused on health-related companies, on the top floor of the second building on the new campus. It will become an incubator aimed at local entrepreneurs and growing companies in establishing health and wellbeing innovations, with offices, labs, co-working and event space available, as well as a Maker Space to support product development. The ground floor will host

a Community Diagnostic Centre Hub (CDC), in partnership with Calderdale and Huddersfield NHS Foundation Trust.

And this is just the start. With plans to develop seven buildings on the campus site over the next decade, as well as complementary initiatives such as Business Kirklees' Thrive and those from across the wider Leeds City Region to drive health and wellbeing innovation, this regional collaborative effort will make significant improvements in both health outcomes and productivity and will transform the future of healthcare.

“
Huddersfield is becoming a significant hub for health innovation in the UK.

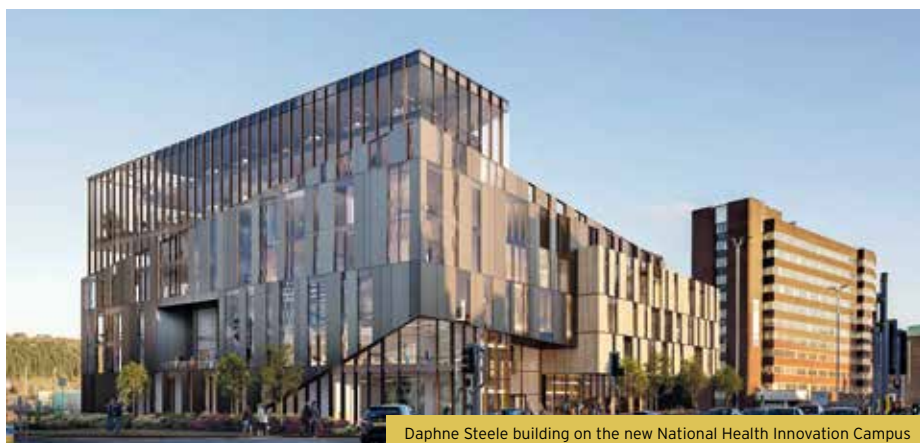

Daphne Steele building on the new National Health Innovation Campus



Artist impression of the second building on the campus

National Health Innovation Campus

www.hud.ac.uk/our-buildings/national-health-innovation/

Join the Health Innovation Network

www.huddshealthinnovation.org

A photograph of the 3M Buckley Innovation Centre, a modern building with a glass facade and brickwork, set against a blue sky with clouds. In the foreground, there are green plants and purple flowers. A large blue triangle is overlaid on the right side of the image.

3M BUCKLEY
INNOVATION
CENTRE

University of
HUDDERSFIELD
Inspiring global professionals

More than office space

Enabling innovation and enterprise

- Office and lab space
- Meeting and event space
- Membership, flexible working and company registration
- Product development expertise

We'd love to hear from you. Get in touch to find out more.
01484 505601 | info@3mbic.com | 3mbic.com

Innovate . Connect . Grow

THE TOP TEN

1. UK GREETINGS LIMITED

UK Greetings Ltd is a market leader in the Greeting Card Industry being one of the largest direct to retail greeting card publishers in the UK, with a rich history and a significant presence in the market. UK Greetings designs, produces, and distributes a wide range of greeting cards, gift wrap, and related products, catering to all occasions and demographics and has a strong presence in major retail chains, independent card shops, and supermarkets across the UK, while exporting to various international markets.

The roots of UK Greetings can be traced back to 1926 when it was founded as Rust Craft, a small family business. Over the decades, UK Greetings has undergone several transformations and acquisitions. In 1980, it became part of American Greetings, one of the world's largest greeting card companies. This association has greatly influenced its growth and market position.

UK Greetings prides itself on its innovative approach to card design. Employing a large team of in-house designers and collaborating with independent artists to create unique and appealing designs, while consistently investing in new printing technologies and finishes to enhance the quality and appeal of its products and

“UK Greetings recognises its environmental and social responsibility and in recent years, has placed increased emphasis on sustainability across its entire business, implementing various initiatives to reduce its environmental impact.

enabling it to adapt to more sustainable and environmental approaches to manufacturing.

UK Greetings recognises its environmental and social responsibility and in recent years, has placed increased emphasis on sustainability across its entire business, implementing various initiatives to reduce its environmental impact, including:

- Using FSC-certified paper sources
- Reducing plastic usage in packaging
- Implementing recycling programmes in production facilities
- Developing eco-friendly product lines

The company invest in people and is proud to be known for fostering a creative and innovative work environment, employing hundreds of people across various departments, including design, marketing, sales, and production.

UK Greetings Ltd stands as a testament to the enduring appeal of greeting cards in an increasingly digital world. Through a combination of tradition, innovation, and adaptability, the company continues to play a significant role in helping people express their sentiments and celebrate special moments. As the greeting card industry evolves, UK Greetings remains at the forefront, shaping the future of personal communication and celebration.



2. OXALIS LOGISTICS UK LIMITED



“

Oxalis Logistics has recently been re-accredited with Earned Recognition Scheme Status by the Driver and Vehicle Standards Agency (DVSA) as a top 2% Elite Operator, demonstrating the highest level of compliance after a comprehensive audit.

In February 2024 The Hoyer group sold part of its portfolio. Now under new ownership and following a major rebranding Hoyer Gas and Petroleum Logistics Limited is now known as Oxalis Logistics UK Limited. The wider Oxalis group is a market leader in the transportation and distribution of bulk fuels and gases in the UK, Germany, Ireland and the Czech Republic, it has over 1,900 trucks and tanks and employs over 2,700 people.

Oxalis delivers logistics solutions for every kind of bulk petroleum-based product and provides intermodal and road solutions for gases. Its team of logistics specialists provide jet A1 fuelling. The company is also a logistics partner to organisations developing solutions to reduce harmful emissions.

Seen as industry leaders when it comes to safety, the business has developed its own state-of-the-art, in-house driver training courses which far exceeds any legal requirements and regulations. The training results in a reduction of safety incidents on the roads and reduced CO₂ emissions through improved fuel economy. Oxalis

Logistics has recently been re-accredited with Earned Recognition Scheme Status by the Driver and Vehicle Standards Agency (DVSA) as a top 2% Elite Operator, demonstrating the highest level of compliance after a comprehensive audit.

Recognising the need to work towards a more sustainable future Oxalis is committed to reducing CO₂ emissions and its fleet consists of the most up-to-date

generations for low environmental impacts. Oxalis Logistics UK has recently joined the Renewable Transport Fuel Association, as part of its focus on transporting biofuels and biogases. It is driving change towards a more sustainable future by helping others to embrace renewable energies. The company is ready and able to transport green gases like H₂, bio-CNG, bio-CO₂, bio-LPG and biofuels.



3. THORNTON & ROSS LIMITED

STADA Thornton & Ross follows a purpose of “Caring for people’s health as a trusted partner”. The company is focused on a three-pillar strategy consisting of consumer healthcare products, generics, and specialty pharmaceuticals and supports Britain’s wellbeing in multiple settings, including consumer healthcare, hospital, primary care, pharmacy, and homecare.

One of the UK’s fastest-growing, leading producers of consumer healthcare products, STADA Thornton & Ross owns trusted brands such as Covonia, Savlon, Hedrin, Nizoral and Cetraben as well as the leading household cleaning brand Zoflora, which is bought by more than two million households.

In addition, the Natures Aid brand sees a dedicated team of natural health experts provide customers with the very best vitamins and natural supplements.

With proven generics and specialty medicines, the company also supports a sustainable and cost-efficient NHS, widening patient access to effective treatments. The portfolio ranges across therapeutic areas including dermatology, respiratory, oncology, ophthalmology, kidney disease, bone health, neurology, anticoagulants, antibiotics, diabetes, and anti-anxiety.

The business has been caring for customers and patients since 1922, and with state-of-the-art manufacturing sites in West Yorkshire and Lancashire, is determined to continue caring for people’s health for generations to come. The Linthwaite manufacturing site is a STADA global centre of excellence for creams production. Around a mile away, the Slaithwaite Commercial HQ provides a next-generation working environment for brand experts, marketers, finance, HR and IT teams.

STADA provides exciting, fulfilling and rewarding careers in a company that values an entrepreneurial spirit combined with agility and collaborative behaviours, and is proud to have been accredited with Top Employer status in the UK.

“
Thornton & Ross has been caring for customers and patients since 1922.



4. MABEY HIRE LIMITED

Mabey Hire is a temporary works specialist and can help clients at any stage of their project.

Mabey can deliver an end-to-end service, from initial concept design to virtual reality rehearsals, through to installation and removal, all by its own in-house teams. The company is headquartered in Dewsbury and has another 17 depots throughout the UK.

Its wide range of temporary works equipment for hire includes;

- Trench boxes or excavation bracing systems for groundworks
- Propping and jacking to support and lift a structure
- Formwork and falsework to create large and small concrete structures
- Temporary ground protection for pedestrian or vehicle access
- Temporary bridges to cross a trench or a major roadway, on foot or in a HGV
- Industry-leading range of environmental and structural monitoring solutions to give you highly accurate real-time data.

Over the past 60 years, Mabey has been honing its engineering experience to create the broadest range of temporary works equipment in the UK, all to enable it to design the right solution for any temporary



works challenge. From getting to site using its temporary bridges and access, to ground shoring or formwork and expert structural support. Mabey can also monitor structures and construction environments before, during and after the build. The company has thousands of clients across the civil infrastructure, buildings and utilities sectors.

Mabey pride itself on its creative engineering, so if they have not encountered the problem before, it will find a solution to bring the project to life. This approach enables it to deliver over 4,000 designed schemes each year of every type and size.

The company is passionate about encouraging the next generation of engineers and has developed its own STEM Education Programme. With engineering expertise at the heart of it, the company feels it has a responsibility to secure the future of the engineering profession, and its business, by encouraging the next generation of engineers. This 16-week programme for school children aged 10-13 has fun at its core. It was piloted in 2017 and had fantastic feedback from school children and teachers alike. At the end of the pilot programme 95% of the children who took part said they would now consider a career in engineering.

“Over the past 60 years, Mabey has been honing their engineering experience to create the broadest range of temporary works equipment in the UK.”



5. DR. REDDY'S LABORATORIES (EU) LIMITED

Dr. Reddy's is a multinational pharmaceutical company guided by its purpose to accelerate access to affordable and innovative medicines. It has over 24,000 employees worldwide and millions of patients have access to Dr Reddy's products in over 66 countries.

Since Dr. Reddy's established themselves in the UK it has supported the UK's healthcare system with its affordable prescription and over-the-counter medicines portfolio. The company's presence in the UK includes its Active Pharmaceutical Ingredient (API) manufacturing site in Mirfield which is part of Dr. Reddy's global network of API and formulation manufacturing sites. The Mirfield team specialises in producing complex APIs in accordance with the quality standards of the UK Medicines and Healthcare products Regulatory Agency and international regulatory authorities.

The company has an industry-leading portfolio of generic APIs and a proven track record in drug product development.

Dr. Reddy's thrives on the deep technical strengths established over the last 30+ years in developing and manufacturing complex APIs such as steroids, peptides, complex long-chain molecules, and highly potent APIs.

The API business is a key pillar of Dr. Reddy's pharmaceutical operations. Starting from its journey as a bulk drug manufacturer in 1984, it has grown to be a leading developer, manufacturer and supplier of APIs globally.

“
Dr. Reddy's supports the UK healthcare system with its affordable prescription and over-the-counter medicines portfolio.

Dr. Reddy's won the API Supplier of the Year Award at the Global Generics and Biosimilars Awards for three consecutive years in a row in 2019, 2020 and 2021. It plans to grow the API business by launching new products through backward integration into core molecules, and by boosting its business in key locations.



6. ALFRED BAGNALL AND SONS LIMITED



Trading as Bagnalls the business is a professional painting and decorating contractor. It is committed to meeting the requirements of its customers from a wide range of sectors, from heritage properties and commercial premises to utilities and rail. Bagnalls holds numerous accreditations

to demonstrate its commitment to; health & safety, the environment, quality, being a fair employer and continuously improving and innovating.

Founded in 1875 the company's first project was to paint a bridge in Charlestown, Shipley for £258. Railways were also a

“
recently named Top UK Family Business Apprentice Employer in 2003

key market sector which saw Bagnalls working nationally for many of the leading rail companies of the time, including the Midland Railway and the North Eastern Railway. This 5th generation family business is steeped in history, so much so that in 2021 the history was chronicled in a book Nothing Ventured, Nothing Won, the story of Alfred Bagnall and Sons Ltd. Next year the business will celebrate its 150th Anniversary.

The business has won a multitude of awards over the years and was recently named Top UK Family Business Apprentice Employer in 2023 with director, Stephen Bagnall named in the Top 100 Family Business influencers in the same year by Family Business United (FBU).

7. AFLEX HOSE LIMITED

Aflex Hose is part of the **Watson-Marlow Fluid Technology Solutions (WMFTS)**, a wholly-owned subsidiary of **Spirax-Sarco Engineering plc** which is a **FTSE 100 listed company**.

Aflex Hose innovates, develops, manufactures and assembles the widest and most technically advanced range of PTFE-lined flexible hose products. Its products are used globally by food and drink manufacturers and throughout the automotive and pharmaceutical industries.

The company has operated for over 40 years. In 2020 Aflex Hose opened its brand-new manufacturing site. The new facility consolidated Aflex's original 5 Kirklees sites into one purpose-built site, with the intention of boosting productivity, being able to offer new products and creating new long-term employment opportunities.

Its patented design of the PTFE liner used in its hoses allows the liner to expand around the outside and compress around

the inside of a bend. This helps to retain a smooth circular bore throughout the hose, without distortion. This is one of the reasons its customers have standardised on the company's hose products in their manufacturing processes.



8. MAC'S TRANSPORT (NORTHERN) LIMITED

Mac's Truck Sales is the **UK's leading family-run commercial vehicle dealer and truck body-builder, offering vehicle sales, rental, and recently finance. The company is renowned for producing some of the UK's finest trucks that are built to last, work hard, and make light work of hard work for its customer's application.**

Over 5 decades of operations, the business has come to perfect just about every type of rigid truck in the market, including Beavertails, Crane Trucks, Curtainsiders, Tippers, Hook & Skiploaders, Removal Vehicles, and Tractor Units, for sectors such as Construction, Haulage, Transport, Power Generation, Telecomms, Retail, and even Film & TV!

Despite growing exponentially over the years, the firm has stayed true to its roots and Huddersfield has always remained as the firm's HQ and production facility, employing, investing in, and developing nearly 100 highly skilled local people from across the district. Acting as a one-stop-shop, everything from initial design, right up to the vehicle delivery is completed



in-house, with 15 (soon to be 21) work bays, paint booths, Laser-cutting, shot-blasting, and valeting all working seamlessly together to create customers' bespoke vehicles.

The large production capacity allows Mac's to keep an immense stock of over 500 ready-to-go trucks and Chassis from manufacturers including DAF, Volvo, Mercedes-Benz, Scania, and MAN, this means customers can purchase a new vehicle in a matter of weeks not months.

Family values remain at the core of the business, and it has recently partnered with local charity, The Welcome Centre, to focus its fundraising efforts, which for 2024 have included Tough Mudders, Marathons, Quiz nights, and even dress-down days to raise funds for the important cause.





HM Government

5 reasons to join HELP TO GROW. MANAGEMENT



1. Course cost

Help to Grow is 90% funded by the government - the full cost is £7500 so you only pay £750! Your business may also be eligible for a bursary to contribute towards your costs.

4. Alumni community

Gain access to exclusive events and networking opportunities as part of the Help to Grow alumni community.

2. Business network

Access to a business network where you can learn from peers and connect with other local business leaders.

5. Custom business support

Receive support developing a custom growth action plan and access an experienced business mentor.

3. Teaching team

Dynamic teaching team and industry professionals will equip you with the essential skills to grow your business.



Scan to learn
more



**HUDDERSFIELD
BUSINESS SCHOOL**

enriching lives
enhancing organisations
engaging communities

TIED AT 9TH PLACE

9. COGRI GROUP LIMITED

The CoGri Group is a Consortium of Floor Solution Specialists with over 34 years of global experience in the design, construction, testing, surveying and upgrading of industrial concrete floors. It provides a full range of services for industrial, commercial / warehouse, and automated flooring requirements.

The CoGri Group are members on the Board of Governors for the UK's Association of Concrete Industrial Flooring Contractors (ACIFC) and formed part of the working party for the latest edition of the Concrete Society's Technical Report 34, a guide to design and construction of concrete industrial ground floors. The Group has also given advice to working

parties of UK, European and ISO standards on matters of floor surface regularity.

The CoGri Group of companies provides industry-leading warehouse flooring solutions supported by advanced, innovative engineering systems and processes. The group's UK based services comprise of four operating companies, **Concrete Grinding Ltd** which specialises in upgrading concrete floors in warehouses and distribution centres, **Face Consultants Ltd** which is an independent floor testing organisation using the latest digital measuring equipment to survey and test warehouse floors to meet flatness specifications, **CG Flooring Systems Ltd** which is a leader in concrete floor repairs and refurbishments in commercial and industrial environments and **CoGri Engineering Ltd** which designs and manufactures specialist floor testing equipment.



9. CROSSROADS GROUP LIMITED

Crossroads Group, consisting of Crossroads Truck and Bus Ltd and sister company Hartshorne Motor Services is the biggest independent Volvo dealer in Europe.

Crossroads Truck and Bus Ltd, was one of the first companies in the country to be appointed as an independent Volvo Distributor for Yorkshire. The head office is in Birstall and the company operates out of nine locations across Yorkshire and Lincolnshire and employs over 300 people. It provides a total transport solution for

the industry, from new trucks to used trucks, and parts and servicing for trucks, buses and trailers.

The Birstall depot offers the following services; truck servicing and maintenance, bus servicing and maintenance, MOT preparation and on site testing, trailer service and maintenance, tail lift service, tyre service, air con service, wheel alignment, Ad blue service, 2 years and 6 years tacho calibrations, windscreen repairs, brake roller testing and full factory parts and warranty backup.

The company has recently completed a 163-mile bike cycle challenge riding from Greta Green to its Birstall depot, raising an amazing amount of money for Leeds Children's Charity at Lineham Farm.

“
Crossroads Group provides a total transport solution for the industry.”



Innovation Spotlight

SHOWCASING SOME OF THE MOST INNOVATIVE ENGINEERING COMPANIES IN KIRKLEES.

DIGITAL TRANSIT

Improving transportation through digitisation and automation

Since it was founded in 2018, Digital Transit has quickly established itself as a leader in digital transformation and technology solutions.

Based at the 3M Buckley Innovation Centre, it offers state-of-the-art capabilities in machine vision, condition monitoring, cybersecurity and safety-critical software, with a primary focus on the railway sector, delivering tailored solutions that enhance efficiency, security and scalability.

Through strategic collaborations, the company has secured over £1m in funding,

including Eureka Eurostars for developing advanced sensing technologies to improve the safety and efficiency of rail overhead lines.

The company has also received Innovate UK funding to create an AI-powered cybersecurity system and to advance its Digital Twin Energy Grid project.

In 2023, the company won a Cybersecurity Innovate UK competition, embarking on a three-year project in collaboration with the Institute of Railway Research (IRR) at the University of Huddersfield and Heron Technology in Singapore to strengthen cybersecurity resilience in the rail industry.

“Through strategic collaborations, Digital Transit has secured over £1m in funding, including Eureka Eurostars for developing advanced sensing technologies.



HOLDSON

Unleashing the potential of additive manufacturing

Established in 2023, Holdson specialises in electrochemical polishing for metal 3D-printed components for industries such

as automotive and medical, where high-performance and safety are critical. It is a spin-off from local precision engineering company, Holtex.

Its patented 'Electroform' technology

accelerates the post-processing of 3D printed parts, achieving speeds up to six times faster than traditional methods while delivering high-quality results with a minimal environmental footprint.

Based in Skelmanthorpe, Holdson recently participated in the Innovate UK Global Incubator Programme, which included a visit to Singapore to build connections with international markets and collaboration opportunities.

The company has also received funding through Innovate UK's Invest-ability training in 2022, to improve business planning, market research and secure IP audits, as well as securing two Innovate UK Smart awards.

In 2024, it joined the Advanced Machinery & Productivity Initiative (AMPI) to further develop its innovative electrochemical polishing technology and has been given the green light for a funding project worth £1.2million over the next two years.



HR BLOWERS

Pushing the boundaries of blower technology

Founded in 1850, WC Holmes evolved from manufacturing gas equipment to producing industrial blowers. After acquisitions by BHD Engineers, Peabody and Dresser Roots, it became Peabody Holmes. In 2007, Martin Adams acquired it, forming HR Blowers UK Ltd.

It has built a global reputation for reliability, efficiency and excellence in the design and production of high-quality Bi-lobe and Tri-lobe blowers, including its bespoke Holmes Roots type positive displacement blowers. Its blowers offer reduced noise and smoother airflow, tailored to the needs of various industries, including wastewater treatment, food processing and chemical manufacturing.

Based in Holmfirth, HR Blowers is committed to innovation and technology and has worked with the University of Huddersfield on two Knowledge Transfer Partnerships to enhance blower performance, efficiency and bulk solid handling.

The company recently expanded, relocating its engineering and design facility to a purpose-built facility and establishing a test house for analysing blower performance and material conveying characteristics.



KIRKLEES INNOVATION VOUCHER SCHEME



This year's Top 100 initiative presents a timely opportunity to reflect on the success of the Kirklees Innovation Voucher scheme, which ended in March 2024. Funded by West Yorkshire Combined Authority and Kirklees Council, the Innovation Voucher programme was designed to plug a gap in the support system and assist SMEs with grant support for small scale or early-stage innovation activity. The scheme supported the development of new and innovative products or processes - businesses could apply for funding for projects up to £10,000 with the Council funding 50% of the activity up to a maximum of £5,000.

The programme had a target of providing 37 grants to businesses during the lifetime of the initiative but exceeded this, awarding 42 Kirklees Innovation Vouchers to SMEs worth over £176,000. A further £206,000 was leveraged in private investment. Projects supported ranged from tailored or bespoke digital transformation activities such as ERP (Enterprise Resource Planning) systems that greatly improved productivity and the use of AI within the businesses, to brand new product designs, ranging from protective equipment for construction workers to products designed to prevent flooding in the household.

The programme was evaluated externally and all beneficiaries that responded spoke positively of the voucher programme. The programme enabled businesses to develop projects that they wouldn't have completed without the help of the scheme due to funding and time constraints and allowed the Council to build relationships with local SMEs.

Although the local Innovation Voucher programme has now ended, learning from the Kirklees programme has informed the design of the West Yorkshire Combined Authority's Ignite innovation voucher, which offers businesses looking for innovation support for the first time. Ignite vouchers are worth up to £5,000 and will provide 50% of the funding for innovation projects.

If you are considering starting an innovation project and would like to know what support is available for your business please contact Business Kirklees at business.enquiries@kirklees.gov.uk.

“
42 Kirklees Innovation Vouchers were awarded to SME's worth over £176,000.”



A Kirklees Innovation Voucher allowed Skopos Fabrics Ltd to make productivity improvements within its sample department.

THE TOP 100 LIST

Final Rank	Company Name	Accounts Date	Employees		Turnover Year Y		Increase in Turnover			Profit Before Tax		Shareholder Funds		Total
			No.	Rank	Y £000s	Rank	Y-1 £000s	% Increase	Rank	£000s	Rank	£000s	Rank	
1	UK GREETINGS LIMITED	28/02/23	2691	1	129,745	7	84,133	54.21	23	16,646	3	47,853	5	39
2	OXALIS LOGISTICS UK LIMITED	01/03/23	1418	3	169,189	4	138,262	22.37	64	4,769	18	36,810	10	99
3	THORNTON & ROSS LIMITED	02/03/23	637	10	174,375	3	156,993	11.07	92	12,300	4	45,216	6	115
4	MABEY HIRE LIMITED	03/03/23	415	15	53,310	28	42,763	24.66	59	9,773	5	39,284	9	116
5	DR. REDDY'S LABORATORIES (EU) LIMITED	04/03/23	169	42	82,317	16	65,528	25.62	57	19,721	2	81,120	4	121
6	ALFRED BAGNALL AND SONS LIMITED	05/03/23	639	9	54,661	27	43,259	26.36	56	4,448	19	17,189	32	143
7	AFLEX HOSE LIMITED	06/03/23	357	19	35,743	37	29,513	21.11	67	2,921	29	29,909	15	167
8	MAC'S TRANSPORT (NORTHERN) LIMITED	07/03/23	73	98	72,955	18	49,394	47.70	28	8,220	8	20,292	25	177
9	COGRI GROUP LIMITED	08/03/23	155	47	24,531	60	17,863	37.33	41	6,833	11	18,364	30	189
9	CROSSROADS GROUP LIMITED	09/03/23	334	20	117,561	9	107,942	8.91	103	7,887	10	10,037	47	189
11	FLEXITALLIC UK LTD	10/03/23	237	29	40,367	33	30,407	32.76	44	920	81	35,471	11	198
12	ISAAC TIMMINS LIMITED	11/03/23	388	16	69,361	20	67,986	2.02	127	3,570	23	34,750	13	199
13	CONTINENTAL WINE & FOOD LIMITED	12/03/23	224	36	95,762	13	94,588	1.24	130	5,515	14	32,912	14	207
14	JOHN HORSFALL & SONS(GREETLAND),LIMITED	13/03/23	53	125	29,871	50	10,672	179.89	6	5,096	16	18,780	29	226
15	HIGH SEAT HOLDINGS LIMITED	14/03/23	485	13	54,835	26	49,620	10.51	93	1,668	54	7,123	65	251
16	CHEMFIX PRODUCTS LIMITED	15/03/23	94	74	27,602	55	21,087	30.90	45	3,281	26	8,961	52	252
17	CAMIRA GROUP HOLDINGS LIMITED	16/03/23	659	8	91,078	14	83,869	8.60	104	3,835	22	4,371	105	253
18	PPG ARCHITECTURAL COATINGS UK LIMITED	17/03/23	1349	4	278,493	2	290,775	-4.22	255	34,873	1	303,960	1	263
19	STORK BETA LIMITED	18/03/23	539	11	144,067	6	125,982	14.36	81	8,154	9	657	158	265
20	AY & Y. PATEL (DEWSBURY) LIMITED	19/03/23	85	79	40,729	31	34,503	18.04	72	1,682	53	13,660	37	272
21	RAMSDENS SOLICITORS LLP	20/03/23	234	33	20,354	77	18,617	9.33	99	8,691	7	8,003	58	274
22	J.T.ELLIS AND COMPANY LIMITED	21/03/23	190	39	30,114	46	18,036	66.97	14	286	117	7,717	61	277
23	HARTFORD HOLDINGS GROUP LIMITED	22/03/23	232	35	40,687	32	39,196	3.80	118	1,254	66	17,228	31	282
24	HOLMEFIELD GROUP LIMITED	23/03/23	237	29	27,439	56	27,439	0.00	138	2,417	40	21,271	24	287
24	MRC GLOBAL (UK) LIMITED	24/03/23	73	98	38,174	34	38,114	0.16	136	5,969	12	43,859	7	287
26	FINTEL PLC	25/03/23	501	12	64,900	21	66,500	-2.41	248	9,600	6	102,900	3	290
27	CATERERS CHOICE LIMITED	26/03/23	37	144	84,828	15	70,952	19.56	69	3,858	21	10,698	43	292
28	CUTWEL LIMITED	27/03/23	92	75	25,988	57	23,555	10.33	94	5,587	13	8,627	54	293
28	STATUS INTERNATIONAL (UK) LTD	28/03/23	83	84	47,132	30	47,051	0.17	135	3,044	27	28,626	17	293
30	BROOKFIELD PROPERTY (HOLDINGS) LTD	29/03/23	105	69	37,369	35	34,694	7.71	108	1,977	43	11,111	40	295
31	THOMAS BROADBENT & SONS,LIMITED	30/03/23	158	45	30,091	47	20,742	45.08	29	232	124	7,860	60	305
32	POLYSEAM LIMITED	31/03/23	130	56	23,667	62	16,625	42.36	36	937	79	5,475	88	321
33	JEMMTEC LIMITED	01/04/23	237	29	25,275	58	24,687	2.38	126	744	88	23,949	21	322
34	FMG SUPPORT (RRRM) LTD	02/04/23	4	209	163,313	5	94,002	73.73	12	1,276	63	14,580	35	324
35	FOCUS INTERNATIONAL LIMITED	03/04/23	292	22	123,655	8	135,857	-8.98	273	4,016	20	42,958	8	331
36	FERNO (UK) LIMITED	04/04/23	59	118	17,916	87	14,598	22.72	62	2,794	31	12,744	38	336
37	OWENS-CORNING VEIL U.K. LTD.	05/04/23	101	71	14,917	102	13,358	11.67	89	1,365	59	27,910	18	339
38	SPEED PETROLEUM (UK) LIMITED	06/04/23	50	130	35,238	39	28,751	22.56	63	1,973	44	6,083	79	355
39	LAWTON CAPITAL LIMITED	07/04/23	238	28	32,740	43	16,585	97.40	10	118	135	2,072	141	357
40	BROOK CROMPTON UK LIMITED	08/04/23	46	136	22,995	68	18,870	21.86	65	1,898	48	10,721	42	359
41	HAROLD HINCHLIFFE LIMITED	09/04/23	98	72	13,035	114	11,155	16.85	74	1,115	72	19,682	28	360
42	CALDERDALE AND HUDDERSFIELD SOLUTIONS LTD	10/04/23	361	18	104,198	12	87,675	18.85	71	253	121	1,346	148	370
43	EASTWOOD GROUP (HUDDERSFIELD) LIMITED	11/04/23	210	38	18,235	84	15,851	15.04	79	609	94	5,997	83	378
44	ZF CV DISTRIBUTION UK LIMITED	12/04/23	36	146	48,903	29	47,274	3.45	121	1,934	46	10,952	41	383
45	THE HENNESSY PARTNERSHIP LIMITED	13/04/23	88	78	5,876	157	4,554	29.02	49	1,569	55	10,090	46	385
46	CRISTOBAL CONSULTING LTD	14/04/23	51	128	24,588	59	13,368	83.93	11	466	106	5,867	86	390
47	VIDECON HOLDINGS LIMITED	15/04/23	64	112	30,006	49	25,051	19.78	68	981	78	5,900	84	391
48	RELIANCE RG LIMITED	16/04/23	258	26	30,079	48	30,789	-2.31	247	1,893	49	23,948	22	392
49	PC SPECIALIST LIMITED	17/04/23	237	29	115,843	11	138,099	-16.12	287	2,740	33	16,907	33	393
50	MAJOR RECRUITMENT LIMITED	31/03/23	247	27	58,312	23	48,055	21.34	66	269	119	515	162	397

Final Rank	Company Name	Accounts Date	Employees		Turnover Year Y		Increase in Turnover			Profit Before Tax		Shareholder Funds		Total
			No.	Rank	Y £000s	Rank	Y-1 £000s	% Increase	Rank	£000s	Rank	£000s	Rank	
51	HARGREAVES GROUP (GB) LIMITED	30/09/22	84	83	20,641	75	16,295	26.67	55	735	90	4,473	102	405
51	PAXMAN COOLERS LIMITED	01/10/22	57	122	8,774	139	6,239	40.62	38	2,508	37	6,911	69	405
53	DAVID BROWN SANTASALO UK LIMITED	02/10/22	373	17	57,268	25	57,913	-1.11	240	377	111	26,707	19	412
54	SPECIALIST GLASS PRODUCTS LIMITED	03/10/22	108	66	11,940	123	9,624	24.07	60	1,935	45	3,129	124	418
55	NATIONAL FLOORCOVERINGS LIMITED	04/10/22	121	59	22,419	69	22,517	-0.43	236	2,783	32	19,871	27	423
56	FUTURE FORWARDING COMPANY LIMITED	05/10/22	41	141	35,436	38	31,175	13.67	82	1,913	47	3,462	119	427
57	W.T.JOHNSON & SONS(HUDDERSFIELD)LIMITED	06/10/22	111	65	7,443	150	5,759	29.24	48	850	83	5,527	87	433
58	UNITED ANODISERS LIMITED	07/10/22	50	130	8,771	140	6,067	44.55	32	2,659	34	4,527	100	436
59	VP MED GROUP LIMITED	08/10/22	27	153	14,953	101	13,841	8.03	107	2,456	38	11,394	39	438
60	BRISANT SECURE LTD	09/10/22	63	113	16,575	93	15,994	3.63	119	1,982	42	6,640	73	440
61	ARROW COMMERCIAL HOLDINGS LIMITED	10/10/22	75	95	13,137	113	12,463	5.41	114	1,566	56	7,235	63	441
62	OREAN PERSONAL CARE LIMITED	11/10/22	273	25	31,574	45	32,777	-3.67	252	1,046	76	8,490	55	453
63	IAN FIRTH HOLDINGS LIMITED	12/10/22	107	68	19,452	83	19,452	0.00	138	1,174	70	4,649	97	456
64	WOOLTEX U.K. LIMITED	13/10/22	158	45	23,159	66	24,828	-6.72	264	2,575	35	9,846	48	458
65	HYSTAT HOLDINGS LIMITED	14/10/22	114	64	12,244	120	11,620	5.37	115	773	86	6,408	75	460
65	NEWSMITH STAINLESS HOLDINGS LIMITED	15/10/22	82	86	15,571	97	15,521	0.32	133	567	100	10,585	44	460
67	PHOENIX TEXTILES LIMITED	16/10/22	173	40	19,497	82	22,440	-13.12	281	2,565	36	23,220	23	462
68	WESTEX (CARPETS) LIMITED	17/10/22	77	92	23,146	67	24,125	-4.06	253	4,842	17	15,220	34	463
69	INTERIOR GOODS DIRECT LIMITED	18/10/22	50	130	36,221	36	37,933	-4.51	257	5,183	15	20,276	26	464
70	BOWER ROEBUCK & CO.,LIMITED	19/10/22	70	102	10,493	130	8,250	27.19	53	832	84	4,668	96	465
70	TANDEM 1987 LIMITED	20/10/22	292	22	116,401	10	125,459	-7.22	266	299	116	9,356	51	465
72	ARROW INDUSTRIAL GROUP LIMITED	21/10/22	115	63	16,736	91	14,526	15.21	78	405	108	3,097	126	466
73	FLAIR FURNITURE LTD	22/10/22	19	162	19,762	81	12,350	60.01	21	1,187	68	2,430	138	470
74	PENNINE INDUSTRIAL HOLDINGS LIMITED	23/10/22	70	102	8,008	146	6,865	16.66	76	1,186	69	5,457	90	483
75	CLARKE MEATS LIMITED	24/10/22	42	140	20,681	74	20,681	0.00	138	1,236	67	7,038	67	486
76	ALLSOP HOLDINGS LIMITED	25/10/22	133	55	12,168	121	11,074	9.89	98	571	99	3,740	115	488
77	RICHARD ALAN ENGINEERING COMPANY LIMITED	26/10/22	127	58	15,562	98	13,865	12.24	88	393	110	2,509	135	489
78	FORTEQ (UK) LIMITED	27/10/22	63	113	13,298	110	11,392	16.74	75	436	107	5,092	93	498
79	TOG 24 LIMITED	28/10/22	289	24	33,182	42	29,272	13.36	83	-352	294	8,101	57	500
80	PATRICK CONSTRUCTION GROUP LIMITED	29/10/22	25	156	23,750	61	23,750	0.00	138	1,527	57	5,458	89	501
81	NL COMMERCIALS HOLDINGS LIMITED	30/10/22	53	125	21,301	72	22,868	-6.85	265	3,283	25	28,946	16	503
82	THOMAS OWEN CARE LIMITED	31/10/22	151	48	5,845	158	5,653	3.41	122	761	87	5,407	92	507
83	CALDER GROUP (DEWSBURY) LIMITED	01/11/22	160	44	14,679	104	14,815	-0.92	238	927	80	10,257	45	511
84	CRAIG'S MOTORCYCLES LIMITED	02/11/22	22	160	14,186	108	13,211	7.38	109	1,265	65	6,746	70	512
85	ANGLOCO LIMITED	03/11/22	167	43	33,838	41	23,429	44.43	33	-641	304	4,610	98	519
86	CONTINENTAL SPORTS LIMITED	04/11/22	77	92	7,376	153	5,263	40.15	40	251	123	3,669	116	524
87	MEDICARE CHEMISTS LIMITED	05/11/22	61	116	9,471	135	9,471	0.00	138	1,337	61	6,081	80	530
88	KIRKLEES STADIUM DEVELOPMENT LIMITED	06/11/22	306	21	5,510	159	2,399	129.65	8	-498	297	9,570	49	534
89	AUTOMINT LIMITED	07/11/22	48	134	11,317	124	11,317	0.00	138	1,072	75	7,055	66	537
90	SOUTHERN WIND GROUP LIMITED	08/11/22	430	14	20,321	78	14,825	37.07	42	280	118	-23	292	544
91	OAKWOOD KITCHEN DESIGN CONSULTANTS LIMITED	09/11/22	40	142	8,519	141	6,679	27.54	52	473	104	4,330	106	545
91	QUEBEC HOLDINGS LTD	10/11/22	83	84	12,113	122	7,555	60.33	20	14	176	1,869	143	545
91	SALAMANDER HASKELL HOLDINGS LIMITED	11/11/22	58	121	6,301	154	6,301	0.00	138	864	82	9,489	50	545
94	LOCALA COMMUNITY PARTNERSHIPS C.I.C.	12/11/22	1469	2	78,097	17	75,910	2.88	124	-2,320	310	4,795	94	547
95	DURA BEDS LTD	13/11/22	171	41	12,893	117	12,542	2.79	125	122	134	2,708	133	550
96	T2100 GROUP LIMITED	14/11/22	27	153	17,091	90	17,091	0.00	138	1,346	60	4,078	111	552
97	GREEN & BROWN LTD	15/11/22	148	49	20,619	76	21,564	-4.38	256	543	101	6,680	72	554
98	STANDARD WOOL UK (HOLDINGS) LIMITED	16/11/22	77	92	32,279	44	34,939	-7.61	269	1,087	73	6,161	78	556
99	TMD FRICTION UK LIMITED	17/11/22	670	7	71,375	19	78,581	-9.17	275	-4	254	120,945	2	557
100	STAFFORD MILLS LIMITED	18/11/22	56	124	4,674	165	4,674	0.00	138	3,422	24	4,124	110	561

LANGRICKS

Chartered Accountants | Wealth Management

*Strategic Accountancy
Built Around You*



We understand that no two businesses are the same, which is why our services are built around you, going beyond just accounting to focus on using numbers to help you achieve your business & personal goals.

Strategy

- ✓ Financial modelling
- ✓ Strategic consultancy
- ✓ Acquisitions, mergers & sales
- ✓ Business restructuring
- ✓ Tax restructuring
- ✓ Company formation & secretarial services
- ✓ Grants & funding
- ✓ Accounting technology set-up

Accountancy

- ✓ Annual accounts
- ✓ Audits
- ✓ Personal tax returns
- ✓ VAT returns
- ✓ CIS returns
- ✓ Bookkeeping
- ✓ Payroll
- ✓ Tax dispute resolution
- ✓ Corporation tax returns

Protecting your future services

- ✓ Pensions
- ✓ Probate
- ✓ Inheritance tax planning
- ✓ Personal tax planning
- ✓ Trusts
- ✓ Philanthropy & charitable giving

Get in touch: 01484 690 730 www.langricks.com

Strategy | Accountancy | Protecting your future

SIGNIFICANT ORGANISATIONS

UNIVERSITY OF HUDDERSFIELD

The University of Huddersfield received a prestigious Gold rating in the 2023 Teaching Excellence Framework (TEF), the only university in Yorkshire, Humber and the North West to achieve this across all areas.

With nearly 20,000 students, the University excels in fields like Applied Science, Business, Engineering and Arts. It houses world-leading research groups and has invested over £230m in state-of-the-art facilities since 2008.

As a major regional employer, contributing £300m annually to the economy, the University also has a growing reputation as a leader in the field of enterprise, holding three Queens Awards for enterprise and international trade.

KIRKLEES COLLEGE

Kirklees College have over 18,000 students on full-time and part-time courses and apprenticeships.



It provides seven bespoke centres across Kirklees, from two main centres in Dewsbury and Huddersfield, and dedicated centres for Animal Care, Engineering, Process Manufacturing and Higher Education. Its aim is to provide inspirational teaching and ensuring the curriculum is developed with employers to ensure the students can progress once the courses have been completed. Each year Kirklees College trains over 1,000 apprenticeships in over 30 occupational areas and is one of the leading apprenticeship providers in the UK.

KIRKLEES COUNCIL

Kirklees Council is a metropolitan single tier authority, the 13th biggest local authority in the UK in terms of population. It has an elected Leader, Cllr Carole Pattison, and Cabinet structure. Kirklees has a population of circa. 433,000. With the two major centres of Huddersfield and Dewsbury it also encompasses the smaller towns of Batley, Birstall, Cleckheaton,

Denby Dale, Heckmondwike, Holmfirth, Kirkburton, Marsden, Meltham, Mirfield and Slaithwaite.

Within the Council there are four directorates, Public Health & Corporate Resources, Adults & Health, Children & Families, and Place. Within these directorates are many teams providing vital services to local residents and businesses.

CALDERDALE AND HUDDERSFIELD NHS FOUNDATION TRUST

The Trust employs over 6,500 staff to deliver care from its two main hospitals: Huddersfield Royal Infirmary and Calderdale Royal Hospital, as well as in community sites, health centres and in patients' homes. It is also incredibly proud to have almost 150 volunteers within the Trust.

Foundation trusts are public leaders in improving quality in health services. They are part of the NHS – yet decisions about what they do and how they do it are driven by independent boards. Boards listen to their Council of Governors and respond to the needs of their members – patients, staff and the local community.

MID YORKSHIRE TEACHING NHS TRUST

In 2023/24, the Mid-Yorkshire Hospitals NHS trust secured its ambition for teaching status meaning it is now officially the Mid Yorkshire Teaching NHS Trust.

The teaching status is in partnership with the University of Leeds and enables the Trust to enhance its education and training capacity, grow research capability and

provide a platform to enable the delivery of new advances in healthcare, innovative discoveries, techniques and medications.

The Trust employs over 10,000 members of staff to deliver compassionate, expert care for over half a million people every year, in their homes, in the community and across its three hospital sites at Pontefract, Dewsbury and Pinderfields.

KIRKLEES ACTIVE LEISURE

Kirklees Active Leisure (KAL) is a charitable trust made up of a board of 12 trustees. KAL provides fitness and leisure centres across Kirklees. The charity's new strategic direction has a focus of health and wellbeing with an aim to provide high quality services to all of its customers.

Since KAL was created in 2002 more than £60m has been reinvested into local leisure centres by Kirklees Council and KAL. KAL employs approximately 650 people.





Whatever your business, wherever you are on your journey, we're here to help.



Startup



Grow

Whether you are starting your own business, a local SME with growth aspirations or an international investor seeking to relocate, our team of experienced advisors will support you on every step of your journey.





Invest



Workspaces

Perfectly located between **Leeds, Manchester** and **Sheffield**, Kirklees provides access to a market of over 7 million people within a one-hour drive; a highly skilled workforce and competitive commercial property prices.

***We're a great place to invest
and do business.***

Follow us...  

To learn more visit: www.businesskirklees.com
or email us at: business.enquiries@kirklees.gov.uk

SIGNIFICANT COMPANIES

Major companies who contribute a great deal to our business community and offer rewarding careers for local people.

CUMMINS TURBO TECHNOLOGIES

Cummins employs just over 1,000 people at its base on St Andrews Road, Huddersfield, where it manufactures medium to heavy-duty diesel engine turbos.

The story began in March 1952 as Holset Engineering Co Ltd founded by business partners Brian Holmes and Paul Croset -



hence the name Holset which combines their surnames. The business began manufacturing turbochargers in the town in 1958 before it was bought by Cummins in 1973.

Around 40% of the world's lorries are powered by a Holset-branded turbocharger including major names such as Volvo, Scania, DAF, MAN and Ford. Cummins also designs and manufactures turbochargers for buses, trains and ships along with investing in future technologies to make it a greener and more sustainable world in which we live and work in, protecting our planet for future generations.

The company is very community minded and provides volunteers for schemes such as a project to set up a Huddersfield Riverside Nature Park alongside the River Colne near to Huddersfield town centre.



ADARE SEC

Adare SEC helps businesses to communicate with customers as effectively as possible using everything from print to emails and text messages. The company also helps businesses to communicate with people who are vulnerable or have special needs such as sight loss.

Adare SEC was established in 2006 at Clayton West with its roots traced back to the former Waddington Business Forms that was based on the same site. It produces hundreds of millions of important customer communications every year ranging from PINS for credit cards and bank statements to welcome packs for new customers joining businesses ranging from banks to insurance companies.

INCORA (FORMERLY WESCO)

Aircraft consist of tens of thousands of parts but if something needs replacing where do you get it from? Well, Incora! - formed when two major aircraft parts companies Wesco Aircraft and Pattonair joined together in 2020 - have consolidated their Clayton West and Cleckheaton sites into a new one at Mirfield where they employ around 180 people.

It's a global company which stocks well over half-a-million components from more than 6,000 different suppliers

including engines, airframes, landing gear, electronics, bearings, sensors, chemicals and tools. The company has thousands of customers and its huge number of suppliers means customers only need to go to one place for parts rather than trying to source them from individual businesses. Wesco was founded in the USA in 1953 and expanded into Europe in 1988. Pattonair was founded in Weybridge, UK, in 1970.

Major customers include Boeing, Airbus, Rolls Royce, Pratt and Whitney, General Electric and GKN Aerospace.

MARS

Everyone knows about the famous Mars chocolate bars - but that's just a fraction of what this global company does. Mars is also a major manufacturer of pet foods and treats with a factory on Oakwell Way in Birstall where it solely focuses on treats for cats and dogs, such as dental sticks and chews.

Mars is a huge employer for the Kirklees area with well over 1,000 people working in Birstall round the clock on the production lines. The big brand dog and cat food names Mars produces include Whiskas, Pedigree, Iams, Sheba, Schmackos and Cesar. The confectionary brands also include Snickers, Twix, Galaxy and Maltesers along with Orbit chewing gum. Foods include Dolmio pasta sauces and Ben's Original rice.

Mars was founded in 1911 when Frank Mars made the first sweets in the kitchen at his home in Washington, USA. It now employs 130,000 people at 454 sites in 80 countries.

Howarths

Celebrating over 20 years of supporting Kirklees businesses with HR, Employment Law and Health & Safety



hello@howarths-uk.com
www.howarths-uk.com



LV=

LV, specialising in insurance and finance, has had a call centre spread over two floors at the Folly Hall Mills complex in Huddersfield since 2010 and now employs around 380 people.

Formerly known as Liverpool Victoria with a history stretching back to 1843 when 'penny policies' were what the company was most commonly associated with – life insurance at its simplest. The insurance side now also includes home, car, travel and pet. In Huddersfield it specialises in motor insurance and Britannia Rescue vehicle breakdown cover.

As a mutual company it's owned by its policy holders, and has 1.25 million members. It works with a range of financial advisers and through them sells LV= products including life insurance, income protection, investments and retirement income solutions such as equity release and fixed term annuities.

LV= employs around 4,000 people nationwide and has more than 6.5 million customers.

KOBER LTD

In 2007 Forza Foods began supplying Asda with cooked meats from its first factory in Cleckheaton. In 2011, having outgrown this site, it opened a bigger cooked meats factory 12 miles away in Normanton and this became Forza's new home with the site in Cleckheaton turned into a bacon and gammon factory and became Kober.

Now Forza and Kober have grown into a best-in-class manufacturing operation, supplying Asda with products from ham slices to salami and from pizza toppings to party food. Asda-owned International Procurement and Logistics (IPL) bought Forza and Kober in 2016. IPL Chief Executive Nick Scrase said at the time: "Our one defining strategy that drives our business model is to simplify supply chains by cutting out the middle-man and then passing these cost savings onto Asda customers."

Forza and Kober employ almost 400 people in Cleckheaton and around 1,700 in West Yorkshire but is looking to expand its workforce due to ever-increasing demand for its products. They have recently launched a new joint website at www.forzakober.com

SYNGENTA

S yngenta is a world leading agriscience company and has been a major employer in Huddersfield, at its manufacturing premises on Leeds Road, for more than 100 years.

The site makes important crop protection products that help growers meet an ever increasing demand for food, feed and fuel. Economic research has shown that Syngenta operations contribute a staggering £140m GVA to the Kirklees economy each year, underpinning 1,000 skilled jobs. 75% of its workforce are

residents in Kirklees and the company is greatly involved in the local community, supporting more than 40 local community groups and charities in the last 12 months.

Syngenta Community and External Relations Manager, Carl Sykes said: "We continue to grow our site activities, investing in our apprenticeship programme, providing employment opportunities for local people and remain committed to keeping professional and skilled manufacturing jobs in Kirklees for many years to come."



FOX'S BURTON'S COMPANIES UK

Fox's Burton's Companies UK or FBC UK was formed when a Ferrero Related Company acquired two truly amazing biscuit manufacturer's Fox's and Burton's with heritage dating back to 1853 and 1895 respectively.

The merger of Fox's and Burton's as FBC UK has created the second largest branded biscuit baker in Britain. FBC UK make biscuits in several bakeries in England, Scotland and Wales and the company's Batley bakery can be traced back to 1853 when Michael Spedding baked his first

batch of brandy snaps and sold them to shops, traders and shows from his bakery. When his son-in-law, Fred Ellis Fox, took over in 1897 he renamed it F E Fox & Co.

The Batley factory now bakes billions of biscuits a year that are munched worldwide. FBC UK produces some of the UK's most iconic brands such as Maryland cookies, Fox's Fabulous Cookies, Jammie Dodgers, Fox's Fabulous Selection, Fox's Chocolatey, Paterson's shortbread, Rocky, Party Rings, Wagon Wheels, Crunch Creams and Thomas Fudge (just to name a few!)

JOHN COTTON GROUP

John Cotton Group is the UK's leading manufacturer of pillows, duvets, toppers, mattress protectors and mattress components utilising the latest fibre technologies.

This Mirfield-based family company was set up in 1916 and now has a 1,500-strong workforce across the globe of which circa 1,000 employees are located in the UK. The Group has a number of manufacturing and warehousing operations in the UK as well as production facilities in Poland, Bulgaria and Australia. John Cotton Group owns a

series of leading bedding brands including Slumberdown and Snuggledown brands in the UK, Dunlopillo in Central Europe and Tontine in Australia.

The company is led by its Chair, Mark Cotton, who has recently taken on this roll from his father, John Cotton. The business' sustainability credentials are impressive, diverting an estimated 1.5 billion plastic bottles from landfill to recycle them in its products. Its EarthKind brand is the first bedding product to be certified as Zero Waste to Landfill.

100 NOT OUT

Celebrating resilient local businesses

The 2023/24 edition of the Kirklees Top 100 Companies showcased a number of local businesses celebrating over 100 years of trading, including John Brooke and Sons, believed to be the oldest family business in the UK, founded in 1541!

The initial article merely scratched the surface and highlighted many other examples of local firms that have been in business for more than 100 years and demonstrating inspiring levels of resilience and a commitment to the communities in which they are located. These firms, like those featured last year, are woven into the fabric of our economy and our industrial heritage. Here's to the next century!



THE STANDARD PATENT GLAZING COMPANY LIMITED

Founded in 1902, the Standard Patent Glazing Company has been manufacturing Patent Glazing systems, bars and ancillaries for over 100 years. The company has installed millions of square metres of Patent Glazing throughout the decades and examples of its finished work can be seen on many prestigious buildings including The Queen's Gallery in Buckingham Palace.

Based in Dewsbury, today the company offers five different Patent Glazing systems to suit all needs ranging from the very modern to its unique heritage system which is suitable for Grade 1 listed buildings.

J. & J.W. LONGBOTTOM LIMITED

Although J & J W Longbottom celebrated its centenary as a Limited Company in 2019, the business has been trading since the 1870s and still operates from its original foundry in Holmfirth. The company manufactures cast iron rainwater products including gutters, rainwater pipes and fittings, ornamental rainwater heads and air bricks.

J & J W Longbottom was formed as a partnership between brothers Joe and Joshua Woodhead Longbottom. In the late 19th century as well as rainwater goods, the company diversified producing lampposts, grates and other goods.

Today, Longbottom's remains a family-run business and production continues today following the same age-proven, traditional methods, but augmented where appropriate by modern materials and practices.



WM HARDILL SONS & CO LIMITED

Wm Hardill Sons & Co. Ltd. specialises in the design and manufacture of precision-engineered process rolls and conveyor pulleys and drums. The company is an eighth generation family company with historical foundations dating back to 1874 as millwrights, supplying local textile companies with pulleys and line shafting to

drive the carding machines and looms.

Today Wm Hardill & Sons utilises advanced design and manufacturing capabilities to supply sophisticated components for applications in industries as diverse as steel processing and textiles through to mining, quarrying and construction.

LONGWOOD ENGINEERING COMPANY LIMITED

Longwood Engineering Company Limited was incorporated in 1902. In the early 1900s the company produced the first screen to recover woollen fibres from waste water. In the 1960s the UK Government noted that Victorian treatment sites needed investment so Longwood Engineering saw an opportunity to provide

automatic screens to the sites. Since then the company has adapted its products to meet new demands – the company works with organisations who need advanced water filtration expertise from municipal water and wastewater companies to fisheries, distilleries, dairies and abattoirs, nationally and across the globe.

BRIERLEY BROTHERS LIMITED

Gardiner Yarns is the trading name of Brierley Brothers Ltd, a highly successful wool spinning company established in 1896.

business, Gardiner of Selkirk. Gardiner of Selkirk had similar strengths and heritage to Brierley Brothers Ltd.

The strong reputation of Brierley Brothers Ltd, developed over the last century, continued to grow and in 2001 it acquired the Scottish woollen yarn spinning

Gardiner Yarns continues to develop, retaining the strength of its heritage and traditional values whilst incorporating modern innovation and processes.

INVESTING IN OUR WORKFORCE

Kirklees businesses leading the way

The role of education and skills in boosting business productivity and improving living standards has been acknowledged and embedded in Government policy for many years. Despite this, regional and local labour markets often operate imperfectly - with employers struggling with hard to fill vacancies or young people finding it difficult to get on the career ladder.

Through our Kirklees Top 100 *Careers Edition*, we are working with local employers, schools, further/higher education institutions and training providers to break down some of these barriers and raise awareness of the careers opportunities available through Top 100 employers.

Here, we showcase examples of companies who have demonstrated a clear understanding of their current and future skills needs and are going 'above and beyond' in investing to develop their talent pipeline.



POLYSEAM

Polyseam was established in 1993 as an 'own brand' manufacturer of adhesives, sealants, fillers and passive fire protection products. The business has evolved into a market-leading construction materials manufacturer, employing 140 staff.

Its recruitment strategy is simple; it aims to bring the best talent into every area of the business and believes investing in people is the key to investing in its future. It places emphasis on its recruitment practices, having recently held its first

recruitment open day, whilst also focusing on long-term employee retention.

It has delivered training for employees to improve their basic skills in Maths and English, hosted Staff Inclusivity Days where employees contributions are celebrated, and support its employees wellbeing with an on-site gym, team-building activities, community engagement opportunities and mental health support services.

RELIANCE PRECISION LIMITED

Reliance Precision Limited ('Reliance') has offered an apprenticeship scheme for over 60 years, supporting young engineers starting their careers. The business has worked closely with partners including Kirklees College to shape the development of the curriculum which has now become so popular the business runs its own in-house apprenticeship scheme. The four-year scheme allows the successful candidates to experience all areas of the business from Manufacturing/Assembly Engineer through to Mechatronics Engineer at the company's in house and fully accredited training facility.

Reliance's passion and commitment for using apprenticeship learning to recruit and develop its staff saw it named SME Apprentice Employer of the Year at the West Yorkshire Apprenticeship Awards in May 2024. Apprentices make up approximately 10% of the Huddersfield workforce and 28% of all employees are current or former Reliance apprentices, all helping to create a workforce of skilled engineers to meet the demands of the future. More information on the Reliance apprenticeship scheme can be found on its website.



MAMAS AND PAPAS

Mamas and Papas was established in Huddersfield in 1981, designing, manufacturing and retailing a diverse product range from pushchairs and nursery furniture, to interiors, baby clothing and toys. The business now operates over 30 stores and concessions across the UK and a thriving online business, employing over 200 people.

Since its apprenticeship scheme launch in 2019, 26 apprentices have been employed across multiple areas, with qualifications ranging from Level 3 to Level 7. The business is also committed to engaging with future workforce through visits to local schools, linking the skills learned in education to those needed in business.

Its "Future Conscious Days" are a regular event, collaborating with key brand partners to develop shared approaches to common business challenges like sustainability and climate change, ethical supply chains and equality and diversity. Whilst in 2024, it introduced a company volunteering scheme, where employees can take one day a year to volunteer.

The business places high importance on its colleague journey, celebrating each employees' uniqueness, encouraging a sense of belonging and promoting the sharing of best practice and ideas.

All of these businesses have demonstrated that they fully understand and embrace the benefits that investing in their current and future workforce brings to their productivity, staff morale, business culture and in turn business success.

Kirklees Council's Employment and Skills team works closely with Business Kirklees and key partners including the University of Huddersfield and Kirklees College to help local businesses invest in their workforce and develop their future talent pool. For more information on how we can help contact us on employmentandskills@kirklees.gov.uk

APPRENTICESHIPS AT THE UNIVERSITY OF HUDDERSFIELD



Management and Leadership Apprenticeship Teaching Team

Enhance your Management and Leadership skills with an apprenticeship at the University of Huddersfield.

The University of Huddersfield's dynamic apprenticeship programmes are designed to propel individuals towards becoming better leaders and improving their management skills.

Meet Olivia Sykes, one of the learners on the Senior Leader Apprenticeship. In June 2024, Olivia won the University of Huddersfield's Level 7 Apprentice of the Year award. In this article, Olivia shares the direct impact the apprenticeship has had in her workplace and the invaluable lessons she's learnt.

Why did you decide to join our apprenticeship programme?

As a relatively new manager with just two years of experience, I was keen to get some official training to help me make well-informed decisions and enhance my skills. The apprenticeship offered everything I was looking for in terms of development.

How has the apprenticeship programme impacted your personal development?

I didn't realise the impact the apprenticeship would have, but it's fundamentally changed how I approach everything at work. It's given me the tools to approach anything - be it a change, initiative, problem, or a new project - allowing me to address it comprehensively and consider many different perspectives. Before the apprenticeship, I would rely on intuition, hoping I was making the right decisions. Now, I have a solid foundation to base my decisions on, giving me confidence that I'm doing the right thing.

What impact has your learning had on your current role?

The course content has been directly relevant to our workplace activities. For example, when we learnt about strategy, our organisation was in the midst of setting its strategy. So, after learning something,

I could go into work the next day and begin planning and implementing things.

In one of the sessions for the module 'Strategy and Innovation', we learnt about organisational culture, mission, and vision. In my organisation, we have a strong



Dr Pete Greenan, Apprenticeship Course Leader

“
I couldn't recommend the programme more – it's absolutely brilliant.

mission and vision that's embedded in what we do. However, from the course, I recognised we could do more about organisational values as they are an important tool to guide employee's actions. In a volatile external environment, it's important for people to understand why they come to work every day. The week after the session, I put a proposal to our trustee board and our Chief Exec, and they said they couldn't believe they didn't think about this before! This led to a big staff training day where we discussed the values and gave employees the opportunity to make suggestions. Now, our finalised 6 values are embedded through our frameworks and everything we do. This initiative is the biggest impact that my learning has had in my role, and it all happened in three months!

This immediate application highlights the effectiveness of the apprenticeship approach, which might not be as achievable in a more traditional course format.

How are you finding the support from the tutors and services at the University of Huddersfield?

The apprenticeship team have been incredible from day one. There was a great level of attentiveness and familiarity right from the start of the application process. The tutors are not only knowledgeable but also personable, offering wrap-around support for both personal and course-related issues.

What has been your highlight so far?

The biggest highlight has been the learning on campus with peers from other organisations. I've previously done a management course that was completely online. Although this allowed me to develop a network, it didn't allow for building deeper connections and mutual support. I'm not only learning from the tutors, but also from fellow learners which is a massive bonus. The campus environment is fantastic for collaboration, providing an open and safe space that enhances the overall learning experience.

I couldn't recommend the programme more – it's absolutely brilliant. No matter your level, whether you're at a mid-manager level like me or in a senior role dealing with major strategic initiatives, everyone can gain valuable insights.



Olivia Sykes, Learner on the Level 7 Senior Leader Apprenticeship

Apprenticeship Pathway: Manager to Senior Leader

The University of Huddersfield's funded Leadership & Management apprenticeship programmes, rated OUTSTANDING by Ofsted, will professionalise your people, retain, motivate and reward your talent whilst making a measurable impact on operational delivery and improved efficiency.

Depending on their experience, your employees can start with Level 5 Professional Manager and then progress to an accelerated Level 6 Chartered Manager Degree Apprenticeship. The University of Huddersfield also offers a Level 7 (Master's level) Senior Leader programme as a further progression option. If your employees are already working at a senior level, they can jump straight in at Level 7. Each programme provides an accredited qualification from the **Chartered Management Institute (CMI)**, and there are also flexible top-up options to a full **MSc/MBA**.

This is a very effective way to upskill your employees through supportive government funding and a practical, blended work-based approach to learning.

If you'd like to find out more and discuss how the University of Huddersfield can support your colleagues, including chatting about entry points and progression routes, please contact Apprenticeships@hud.ac.uk



KIRKLEES TOP 100 – THE LIST

1



UK Greetings is a prominent publisher of greeting cards, gift dressings, and social expression products in Dewsbury. It creates products for various occasions, from big events to everyday moments, and is one of the largest direct-to-retail publishers in the UK.

2



Oxalis Logistics UK Limited specialises in the transportation and distribution of bulk fuels and gases. It provides logistics solutions across the UK, Germany, Ireland, and the Czech Republic, with a fleet of over 1,900 trucks and tank trailers.

3



Thornton & Ross Limited part of the STADA group, a global pharmaceutical company, is one of the UK's fastest growing, leading producers of pharmaceutical products. It manufactures a range of well-known brands, including Covonia, Hedrin, Cetraben and Zoflora.

4



Mabey Hire Limited is a leading specialist in temporary works solutions based in Dewsbury. The company provides engineered solutions for civil engineering, building, and utilities projects. It offers a wide range of services, including the design, supply, installation, and monitoring of temporary works.

5



Dr. Reddy's Laboratories (EU) Limited is a subsidiary of Dr. Reddy's Laboratories, a global pharmaceutical company. The EU branch is based in Mirfield. The company specialises in the manufacture of basic pharmaceutical products.

6



Alfred Bagnall and Sons Limited specialises in commercial and industrial painting and decorating projects across the UK. It offers a wide range of services, including painting, decorating, and maintenance for various sectors such as education, healthcare, and infrastructure.

7



Aflex Hose Limited design and manufacture PTFE-lined flexible hoses. The company has over 50 years of experience in producing high-quality hose products. It offers a wide range of hoses for various applications, including pharmaceutical, chemical, automotive, and food processing industries.

8



Mac's Transport (Northern) Limited operates under the brand name Mac's Trucks. Part of Mac's USP is that it is a one stop shop for its customers, dealing with the entire buying, building and aftersales care in house - as such, its primary business activity is the production and manufacture of HGV vehicles.

9



CoGri Group Limited is a global leader in industrial and warehouse flooring solutions. Established in 1989, the company has over 34 years of experience in the design, construction, testing, surveying, and upgrading of industrial concrete floors.

9

CROSSROADS GROUP LIMITED

Crossroads Group Limited is the parent company of Crossroads Truck & Bus Limited. It is a Volvo Truck and Bus specialist. The company offers Truck and Bus sales, parts advice and maintenance.

KIRKLEES TOP 100 – THE LIST

11



Flexitallic UK Ltd is a leading manufacturer of innovative and effective static sealing solutions. It specialises in producing high-quality industrial gaskets and sealing products for various industries. Its headquarters and manufacturing base are located in Cleckheaton.

12



Founded in 1929, Isaac Timmins Limited is better known as Myers Group. Group companies include Readymix Huddersfield, Johnsons Wellfield, Myers Building Supplies and Myers Skip Hire.

13



Continental Wine & Food Limited is a wine and alcoholic drinks wholesaler, producer, bottler, and distributor. CWF offers a wide range of products, including still and sparkling wines, fortified wines, British wines, and speciality mixer drinks.

14



John Horsfall & Sons (Greetland) Limited specialises in the production of high-quality textile products for the aviation industry. It offers a range of items including blankets, cushions, pillows, flight pyjamas, duvets, mattress pads, table linen, and other airline service textiles.

15



High Seat Holdings Limited has a history of providing high-quality furniture, particularly through its brand HSL Chairs, which specialises in posture-supportive furniture designed to enhance comfort and wellbeing.

16



Chemfix Products Limited is a specialist manufacturer and exporter based in Dewsbury. It focuses on producing chemical anchoring, building adhesives, and wood repair products for the professional market.

17



Camira Group is a global organisation made up of a diverse range of specialist manufacturing businesses including Holmfirth Dyers, the textile dyeing and finishing experts within the group, and Camira Yarns, woollen spun yarn specialists.

18



PPG Architectural Coatings UK Limited is a subsidiary of PPG Industries, a global leader in paints, coatings, and specialty materials. The company offers products under well-known brands such as Johnstone's and Leyland.

19



Stork Beta Limited is the parent company of Mamas & Papas. Mamas & Papas is a nursery brand and manufacturer, based in Huddersfield. The company specialises in a wide range of baby products, including prams, pushchairs, baby furniture, clothing, and maternity wear.

20

**AY & Y. PATEL
(DEWSBURY)
LIMITED**

AY & Y. Patel is a family run business based in Mirfield at its redeveloped Service Station on Huddersfield Road. It is an independent forecourt operator with several sites throughout West Yorkshire.

KIRKLEES TOP 100 – THE LIST

21



Ramsdens Solicitors is a full-service law firm, with a history spanning over 150 years. The firm is consistently recognised by leading independent legal guides like The Legal 500. It offers a comprehensive range of legal services for both individuals and businesses.

22



J.T. Ellis & Company Limited is a well-established, family-owned business based in Huddersfield. Founded in 1891, the company has a long history of manufacturing high-quality furniture. It specialises in designing, manufacturing, and supplying kitchen, bedroom, and bathroom furniture.

23



Hartford Holdings Group Limited is the parent company of Trojan Baths. Trojan Baths are based at three sites within Huddersfield and has become one of the largest manufacturers of acrylic baths in Europe.

24



Holmefield Group Limited is the parent company of Highgrove Beds Limited. Highgrove Beds produce approximately 5,000 beds a week from its state-of-the-art manufacturing plant in Liversedge.

24



Based in Cleckheaton, MRC Global (UK) Limited is a distributor of pipes, valves, fittings (PVF), and other infrastructure products and services. It caters to various sectors, including gas utilities, downstream, industrial, energy transition, upstream production, and midstream pipeline sectors.

26



Fintel Plc aims to simplify the retail financial services sector by connecting product providers, intermediaries and consumers through technology, expertise and insight. Fintel Plc has two leading brands SimplyBiz and Defaqto.

27



Caterers Choice is a family-owned business that has operated for over 30 years. It imports canned and ambient foods and supplies its foodservice, wholesale, manufacturing and retail customers, with own, customer and supplier branded goods.

28



Cutwel Limited is a leading supplier of engineering cutting tools in the UK and Ireland. Established in 1996, the company has grown significantly and now offers over 25,000 products. The company operates from its headquarters in Cleckheaton.

28



Status International (UK) Limited is an independent supplier of lighting and electrical accessories. The company has been trading for over 30 years and is headquartered in Birkenshaw. It offers a wide range of products, including light bulbs, cords, plugs, flashlights, and alarms for smoke, gas, and carbon monoxide.

30



Trading as The Brookfield Group and primarily known for its operations in the retail forecourt sector, the company manages a variety of roadside services across the north of England and has ambitious plans to expand its portfolio throughout the UK.

KIRKLEES TOP 100 – THE LIST

31



Thomas Broadbent & Sons Limited, commonly known as Broadbent, is an engineering company based in Huddersfield. Founded in 1864, the company specialises in the design, manufacture, and supply of industrial centrifuges and associated process control equipment.

32



Polyseam Limited is a construction materials manufacturer, specialising in high-performance passive fire protection products, adhesives, sealants, and fillers. Polyseam serves a global market, providing private label products for many well-known brands.

33



Jemtec Limited, trading as Magma Group, is a leading manufacturer and supplier of refractory, ceramic, and catalyst materials. It specialises in high-performance precision-made refractories and thermal ceramics, serving a wide range of industries globally.

34



FMG Support (FIM) Ltd is part of FMG, a provider of end-to-end incident management and specialist vehicle recovery services. It provides 24-hour vehicle and driver support to a variety of clients, including Blue Chip companies, leasing providers, motor insurers, Highways England, and several police forces.

35



Focus International Limited, trading as Focus Brands the company designs, sources, distributes and promotes sports fashion and lifestyle brands. It specialises in clothing, footwear and accessories, building and nurturing leading consumer brands in both the UK and around the world.

36



Ferno (UK) Limited designs, manufactures, distributes, markets and sells products to the emergency services, funeral & mortuary, industrial, aviation, and military sectors. It specialises in patient transportation and rescue solutions.

37



Owens-Corning Veil U.K. Ltd. is based in Liversedge. The company specialises in the manufacture of glass fibres, which are used in various applications including insulation, roofing, and composites.

38

SPEED PETROLEUM (UK) LIMITED

Speed Petroleum (UK) Limited operate petrol stations with convenience stores including Subway outlets and valeting. The company operates a portfolio of sites in the North.

39

LAWTON CAPITAL LIMITED

Lawton Capital Limited is a parent company to Lawton Yarns Limited. Lawton Yarns produces high-quality woollen yarns, primarily for the carpet industry.

40



Brook Crompton is a provider of energy efficient electric motors. The company is focused on the development of products that improve energy efficiency, offer lower cost of ownership throughout their life-cycle and reduce environmental impact.

KIRKLEES TOP 100 – THE LIST

41

Z. Hinchliffe & Sons

Harold Hinchliffe Limited is the parent company of Z.Hinchliffe and Sons Limited based in Denby Dale. It has been a spinner of quality yarn for over 200 years.

42



Calderdale and Huddersfield Solutions Ltd are a wholly owned subsidiary of Calderdale and Huddersfield NHS Foundation Trust. It delivers a comprehensive, estates, facilities, medical engineering & devices training and procurement service to properties owned by the Trust.

43

EASTWOOD GROUP (HUDDERSFIELD) LIMITED

Eastwood Group (Huddersfield Limited) is the parent company to Eastwood Financial Group Limited which includes various subsidiaries offering a variety of services including insurance, risk management and financial planning.

44



ZF CV Distribution UK Limited is part of a global group, ZF Friedrichshafen AG. ZF is a global technology company supplying advanced mobility products and systems for passenger cars, commercial vehicles and industrial technology.

45



The Hennessy Partnership focuses on supporting individuals with complex care needs, including those with dementia, learning disabilities, autism, and other conditions.

46



Cristobal Consulting Ltd is the parent company of 247 Home Furnishings Ltd, trading as 247 Blinds. The business is an online retailer offering high-quality custom-made blinds.

47



Videcon Holdings Limited is the parent company of Videcon Ltd, a leading trade-only distributor of CCTV, fire, intruder and access control products to the UK security market.

48



Reliance RG Limited is the parent of Reliance Precision Limited, a precision manufacturing company. Reliance Precision specialises in engineering solutions across a diverse range of technologies, including gears and geared systems, clean and high vacuum assemblies, and opto-mechanical assemblies.

49



PC Specialist Limited specialises in custom-built PCs, laptops, and servers. Its product range includes high-performance systems tailored for enthusiasts, gamers, and professionals.

50



Major Recruitment Limited is a multi-sector recruitment agency based in Huddersfield. The company specialises in providing bespoke recruitment solutions, and has divisions dedicated to specific sectors such as industrial, commercial, healthcare, and technical recruitment.

KIRKLEES TOP 100 – THE LIST

51



Hargreaves Group (GB) Limited is the parent company of Newlay Concrete Limited, which manufactures lightweight and dense aggregate blocks, foundation and breeze blocks, 'paint-grade' blocks, flooring products and courings.

51



Paxman Coolers Limited has been pioneering scalp cooling technology to help prevent chemotherapy-induced alopecia worldwide for over 20 years.

53



David Brown Santasalo UK Limited, trading as DB Santasalo, designs, engineers and manufactures mechanical power transmission solutions, making it one of the world's leading industrial gear specialists.

54



Specialist Glass Products (SGP) is a family run business and is one of the UK's leading suppliers of curved, flat and bespoke structural glass products. Its portfolio includes installations at well-known locations such as The Shard, The Gherkin, King's Cross Station, and Wembley Stadium.

55



National Floorcoverings produces a wide variety of products from fibre bonded carpets for the education market, tufted carpet and tiles for the commercial sector to specialised indoor and outdoor sports surfaces. It has expertise in all aspects of flooring.

56



Future Forwarding Company is a full-service logistics provider offering key services such as freight forwarding, customs brokerage, ecommerce services, domestic transportation, compliance and consulting and information technology.

57



W.T. Johnson & Sons is a textile dyeing and finishing company. It creates high quality finishes on an ever-increasing range of fabrics, from the finest gentlemen's worsted suiting to specialised safety clothing and upholstery.

58



United Anodisers offer a wide range of anodising treatments in the wide dimensional range. Over the years the company has diversified into markets such as Automotive, Engineering and Decorative, in addition to being the largest supplier of coloured architectural finishes in Europe.

59



Founded in 2003, VP Med Group supply and accelerate the adoption of innovative, patient-focused medical technologies and techniques. It also designs educational programmes to support its products and empower healthcare professionals.

60



Brisant Secure is committed to providing the very best protection for British homes, offering a range of innovative solutions including locks, smart home products, door furniture and accessories that are always secured by design and convenient for the modern UK market.

KIRKLEES TOP 100 – THE LIST

61



Arrow Commercial Holdings Limited, trading as Arrow Self Drive is Yorkshire's largest independent vehicle hire company. Its fleet of hire vehicles consists of vans, trucks, minibuses and cars.

62



Orean is a UK and USA based private-label cosmetic formulator and manufacturer. Its an expert in premium skincare and haircare products, and provides formulation, manufacturing and packaging services to its clients.

63



Ian Firth Holdings Limited, trading as Ian Firth Hardware has been supplying the house builder with quality doors, hardware and associated products for over 30 years.

64



Wooltex designs and manufactures high-quality textile fabrics with a strong focus on wool. The company manufactures fabrics used in office seating, public buildings and concert halls with most of its sales being exported globally.

65



Hystat Holdings Limited is the parent company of Hystat Systems Limited which designs, manufactures and maintains hydraulic cylinders, accumulators, rotary actuators and rotary distributors.

65



Newsmith Stainless Holdings Limited is the parent company of Newsmith Stainless Limited, a family-owned business, manufacturing an extensive and versatile range of industrial washing machines, drying, automated handling, conveying and auxiliary equipment.

67



Phoenix Textiles Limited is a family-owned business based in Huddersfield. Phoenix manufactures and imports ethically sourced textiles in the home textiles industry. Some of its product range includes rugs, bath mats and pet mats.

68



For nearly 40 years, Westex has supplied and manufactured high-quality flooring solutions to both commercial and residential marketplaces. Its floorings are widely used around the world in the hospitality sector, in the homes of royalty, stately homes, prestigious retail outlets and on the sets of blockbuster movies.

68



Interior Goods Direct has traded since 2003, exclusively online. From its facility in Grange Moor it manufactures and supplies all kinds of window dressings from curtain poles to custom blinds.

70



Bower Roebuck is a leading textile manufacturer renowned for producing some of the most luxurious English fabrics and designs. It supplies wool, natural blends and sustainable tailoring fabric to luxury customers and brands globally.

KIRKLEES TOP 100 – THE LIST

70



Tandem 1987 Limited is the parent company of Principal Global Limited. Principal Global supports clients with brand strategy, experience, design and implementation. Headquartered in Huddersfield, with offices and clients all over the world.

72

Arrow provides a wide range of industrial doors in Yorkshire, catering to various commercial and industrial needs. Its selection includes automatic doors, industrial roller shutter doors, and other solutions for businesses.

73

Based in Heckmondwike Flair Furniture manufactures and supplies all types of beds for all types of bedrooms from bunk beds to TV beds as well as mattresses and other furniture.

74



Pennine Industrial Holdings is the parent company of Pennine Industrial Equipment Limited. Pennine Industrial is a family run business that specialises in manufacturing high-quality conveyor chains and sprockets, particularly for the glass industry. It also manufactures a wide range of engineered plastic components.

75

CLARKE MEATS LIMITED

Established in 1995, Clarke Meats supplies poultry, meat and game to farm shops, retail butchers and catering butchers.

76



Allsop Holdings Limited is the parent company of B.Allsop Limited trading as Allsops. Allsops is a precision sheet metal engineering company based in Honley.

77



Richard Allan Engineering offers an end-to-end service, including design, fabrication, machining, installation and maintenance of custom storage tanks, silos, pressure vessels, water and wastewater treatment solutions.

78



Forteq (UK) Limited is the UK arm of a global business. Forteq specialises in the manufacture of plastic solutions, including metal to plastic conversion, tooling and injection moulding, and gears and transmission systems.

79



Tog 24 is a family run business initially producing footwear, then branching into sports bags and football kits in the 70's before finally landing on waterproofs and fleeces. As the brand grew in popularity skiwear and casual clothing were added.

80



Patrick Construction Group Limited is the parent company of Termrim Construction Limited. Termrim Construction Limited is an award-winning, privately owned main contractor specialising in new build developments in the housing and care sectors up to £25m in value.

KIRKLEES TOP 100 – THE LIST

81



NL Commercials Holdings Limited, trading as NL Commercials is a family-owned vehicle rental company that has been supplying vehicle hire solutions for over 38 years. It offers short and long-term lease options. They have a choice of cars, vans and trucks.

82



Thomas Owen Care offer specialist nursing and residential care with two care homes currently in the portfolio and a third under construction in Dewsbury.

83

CALDER GROUP (DEWSBURY) LIMITED

Calder group (Dewsbury) Limited is the parent company to several textile focussed businesses in Kirklees including Calderdale Carpets Limited, Calder Textiles Limited, Calder Dyeing Limited, Calder Carpets limited, Anchor Carpets Limited and Calder Properties Limited.

84



Craigs Motorcycles, based in Dewsbury, is a family-run motorcycle dealership, now firmly established as the UK's largest off-road showroom. Craig has over forty years of experience in motorcycle retail and a wealth of experience competing in Motorcross Trials and Enduro.

85



Angloco Limited is an established and reputable manufacturer of firefighting and rescue vehicles. With a broad range of core activities including design and manufacture, distribution, and after-sales service.

86



Continental Sports manufactures trampolines for rebound therapy, gymnastics training and competitive trampolining, as well as supplying some of the best trampoline and adventure parks in the world.

87



Medicare Chemists is a family-run business running seven chemists located in the Huddersfield area: Bradley, Salendine Nook, Marsh, Lockwood, Honley and two in Holmfirth.

88



Kirklees Stadium Development Limited (KSDL) was established in 1992 and is responsible for managing the John Smith's Stadium, which is home to both Huddersfield Town AFC and Huddersfield Giants.

89



Automint Limited is an importer and distributor of air springs and air suspension components, supplying commercial vehicle motor factories in Great Britain.

90



Southern Wind Group are headquartered in Huddersfield, and operates the Fazenda chain of restaurants in England, offering authentic South American cuisine.

KIRKLEES TOP 100 – THE LIST

91



Oakwood Kitchens work with clients on a full project management basis from concept design to completed installation. It also offers their products on a supply-only basis.

91



Quebec Holdings is the parent company of One Holding North Limited. The principal activities of the group are manufacturing mattresses and divans bases, complementing this with the sale of imported furniture.

91



Salamander Haskell Holdings Limited is the parent company of Salamander Fabrications Limited. Salamander Fabrications is a sheet metal fabrication company specialising in laser cutting, CNC machining, welding, fabrication and powder coating and finishing.

94



Locala Community Partnerships provides NHS community services to over 400,000 people in Kirklees. It offers a wide range of healthcare services.

95



Dura Beds make over 4,500 mattresses and 2,500 divan beds per week. As well as serving the UK market it also exports to Spain, Portugal and Denmark.

96



T2100 Group consists of two companies; ProVu Communications, which specialises in the field of cloud communications and Alliot Technologies, that is a specialist distributor in the field of the Internet of Things.

97



Green & Brown Ltd offers a comprehensive range of interior furnishings, handmade to measure in the UK. This includes vertical blinds, roller blinds and wooden blinds, as well as its luxurious hand-sewn Roman blinds and curtains.

98



Standard Wool UK (Holdings) Limited is the parent of Standard Wool UK Limited. For over 200 years, Standard Wool has been sourcing, cleaning, processing, and selling wool.

99



TMD Friction UK Limited is the UK arm of a global company. TMD Friction designs exceptional brake products for the world's biggest automotive brands, motorsport and industrial applications.

100



Stafford Mills Limited is the parent company of Pacific Lifestyle. Pacific has designed and imported a breadth of home furniture, lighting and home accents for over 50 years.

SPOTLIGHT ON SOME LOCAL CHARITIES MAKING A DIFFERENCE IN KIRKLEES

FRESH FUTURES ONE COMMUNITY

Established in 1974, Fresh Futures is a regional charity that supports vulnerable and disadvantaged children, young people, and their families, within Kirklees and surrounding areas.

Fresh Futures provides early interventions and medium to longer-term support for children and young people who are facing challenges with their social, emotional, and mental health. They offer Warm Spaces and food and fuel vouchers for those in need.

They also offer:

- Brian Jackson College, an alternative education provision for students facing exclusion from school.
- Elevate providing 1:1 and group support to help young people develop their confidence and self-esteem
- Employability Programmes helping young adults aged between 18 - 26 years begin their journey towards finding employment
- A Family Time Centre giving families a safe and secure place to meet to build healthy relationships
- Safety in the Home programme supporting families to reduce the risk and prevent childhood accidents in the home by supplying and fitting home safety equipment
- Stay and Play giving parents and their children a welcoming place to visit

Fresh Futures hosted the Kirklees Top 100 Summer Networking Event in July 2023 at their venue, Brian Jackson House, in Huddersfield.



One Community is a community foundation established in 2010, dedicated to helping philanthropists and businesses in Kirklees make a meaningful impact in their local communities.

By leveraging its deep connections and understanding of local needs, One Community assists companies in delivering effective corporate social responsibility (CSR) initiatives. Through community engagement, relationship-building, and collaboration, it identifies areas where businesses can make a real difference locally. One Community empowers small local charities and grassroots organisations by providing them with essential funding, skilled volunteers, and expert advice. With over £6 million distributed throughout Kirklees, benefiting more than 200,000 people, One Community's responsible fund management has had a significant positive impact. Supported by trustees, members, and corporate partners, it continues to drive change and strengthen the local community.

HUDDERSFIELD TOWN FOUNDATION

The Huddersfield Town Foundation is the official charity of Huddersfield Town Football Club. Their mission is to tackle the consequences of inequality by working to provide positive opportunities and support to the community of Kirklees.

Established in 2012, the Foundation's initial focus was to establish 'Early Kick Off' Breakfast Clubs in schools to ensure that children started their learning day in school with a healthy and nutritious breakfast. Fast forward to 2024 and the Foundation still delivers Breakfast Clubs but they now offer much more, including Sporting Memories sessions to older people who may be isolated or lonely, primary school classroom educational interventions, mentoring and youth work with young people in and outside of school, employment and skills support to care leavers, and support with physical and mental health.





Not sure which path to take? Talk to us today!

We are an award-winning independent Yorkshire Recruitment Agency that has been matching perfect candidates in their ideal jobs, for over 20 years.

We do this by getting to know each and every candidate on a personal level, but more importantly, we excel in understanding your business needs and building lasting relationships.

Specialising in:

Industrial

Engineering

Office

Education



Contact us today on:

01484 35 10 10 (24hours)

International House, Chapel Hill,
Huddersfield, HD1 3EE

www.stafflex.co.uk

KIRKLEES
**TOP
100**
COMPANIES 2024/25

SPONSORED BY

Howarths



LANGRICKS

Chartered Accountants | Wealth Management

OUR PARTNERS

3M BUCKLEY
INNOVATION
CENTRE

University of
HUDDERSFIELD
Inspiring global professionals



KIRKLEES100.ORG | KIRKLEESTOP100@HUD.AC.UK